

GENERAL HIGHWAY MAP WHEELER COUNTY NEBRASKA

PREPARED BY THE
DEPARTMENT OF ROADS
TRANSPORTATION PLANNING DIVISION
IN COOPERATION WITH THE

U.S. DEPARTMENT OF TRANSPORTATION
FEDERAL HIGHWAY ADMINISTRATION

1987

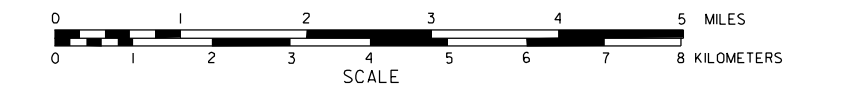

LEGEND

- | | | |
|--|----------------------------|--|
| Primitive Road | Gravel or Crushed Rock | Agricultural Experimental Station |
| Unimproved Road | Asphalt/Bituminous Surface | Educational Institutions |
| Concrete/Brick Surface | Concrete/Brick Surface | Public Use Area |
| Multiple Lane Undivided Highway | Concrete/Brick Surface | Recreational Facilities |
| Divided Highway | Concrete/Brick Surface | Rest Area |
| Interstate Highway with Full Control of Access | Concrete/Brick Surface | Ranger Station |
| State-Numbered Highway | Concrete/Brick Surface | Fish Hatchery |
| US-Numbered Highway | Concrete/Brick Surface | Community Hall |
| State-Numbered Highway Spur | Concrete/Brick Surface | Correctional Institution |
| State-Numbered Highway Link | Concrete/Brick Surface | Tourist Court or Motel |
| Interstate Exit Number | Concrete/Brick Surface | Museum |
| Wide Stream | Concrete/Brick Surface | Manumnt-Small |
| Narrow Stream | Concrete/Brick Surface | Courthouse |
| Irrigation Ditch | Concrete/Brick Surface | Armory |
| Reservoir, Pond or Lake | Concrete/Brick Surface | Post Office |
| Reservoir, With Dam | Concrete/Brick Surface | Highway Maintenance Yard |
| Highway Bridge-Any Type | Concrete/Brick Surface | Dump Area |
| Small Bridges-Closely Spaced | Concrete/Brick Surface | Sewage Disposal Plant |
| Arch Bridge | Concrete/Brick Surface | Water Supply Stand Pipe |
| Truss Bridge | Concrete/Brick Surface | Pipe Line |
| Pedestrian Overpass | Concrete/Brick Surface | Transmission Line |
| Railroad Overpass | Concrete/Brick Surface | Power Plant |
| Railroad Underpass | Concrete/Brick Surface | Power Substation |
| Railroad | Concrete/Brick Surface | Radio or TV Station |
| Dam with Road on Top | Concrete/Brick Surface | Pumping Station |
| Cattle Guard | Concrete/Brick Surface | Weight Station or Port of Entry |
| Dwelling | Concrete/Brick Surface | Commercial or Municipal Airport |
| Row of Dwellings | Concrete/Brick Surface | Airport with Paved Runways |
| Cemetery | Concrete/Brick Surface | State Boundary |
| Church or Other Religious Institution | Concrete/Brick Surface | County Boundary |
| Church with Cemetery Adjacent | Concrete/Brick Surface | Township Line |
| Hospital | Concrete/Brick Surface | Section Line |
| Business | Concrete/Brick Surface | Corporate Limit Lines |
| Industrial Plant | Concrete/Brick Surface | Parks and Other Reservations |
| Filling Station | Concrete/Brick Surface | Boundary Limits of Area Shown in Enlargements |
| Grain Elevator | Concrete/Brick Surface | State Capital |
| Aggregate Pit | Concrete/Brick Surface | County Seat |
| | | Other Cities and Villages |
| | | Incorporated City or Village |
| | | Triangulation Station |
| | | Points Between Which Distances Are Measured Indicated Thus |
| | | Latitude and Longitude |

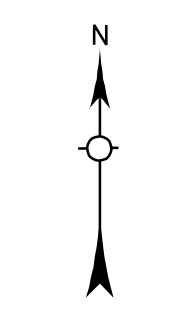
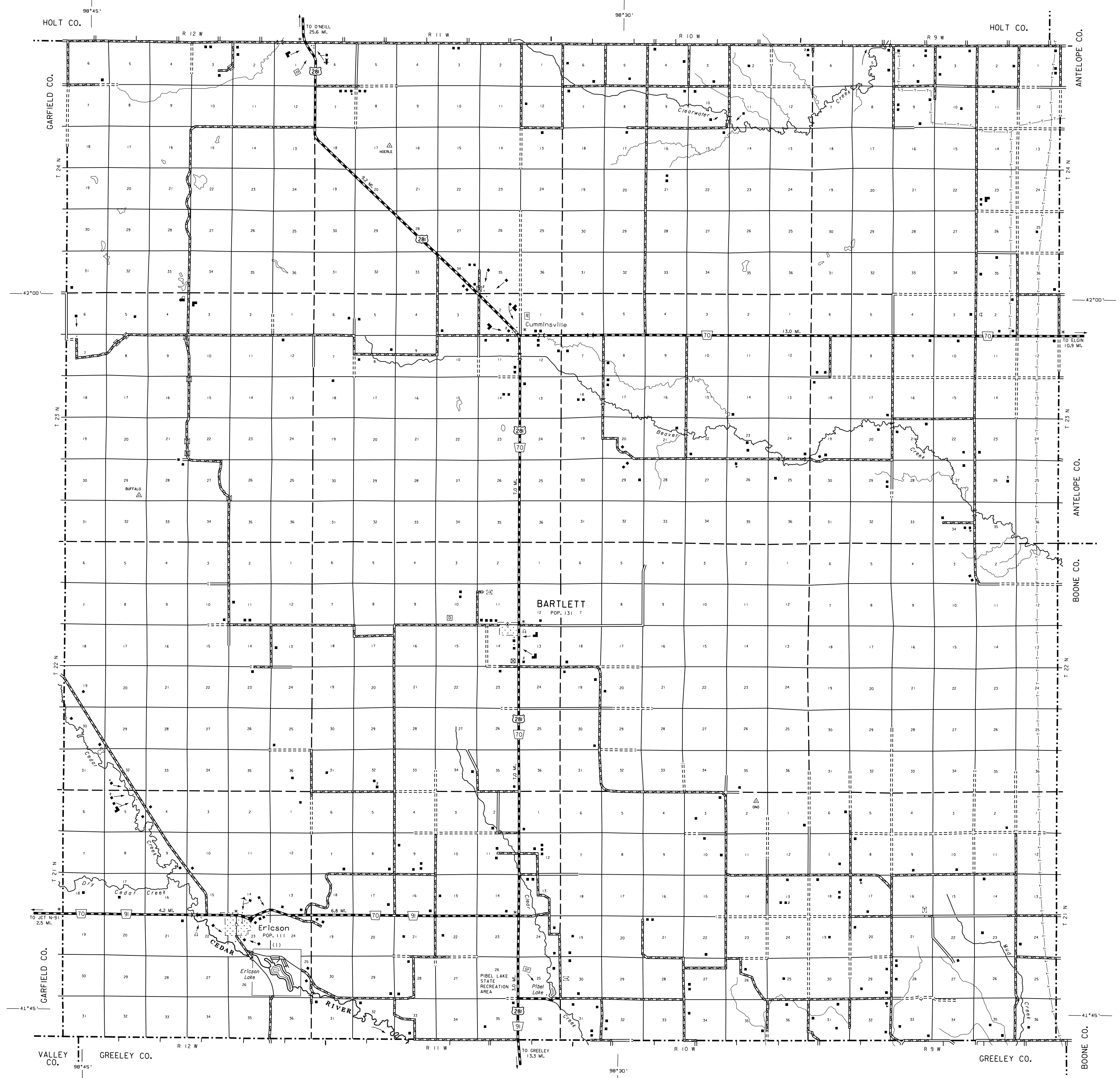
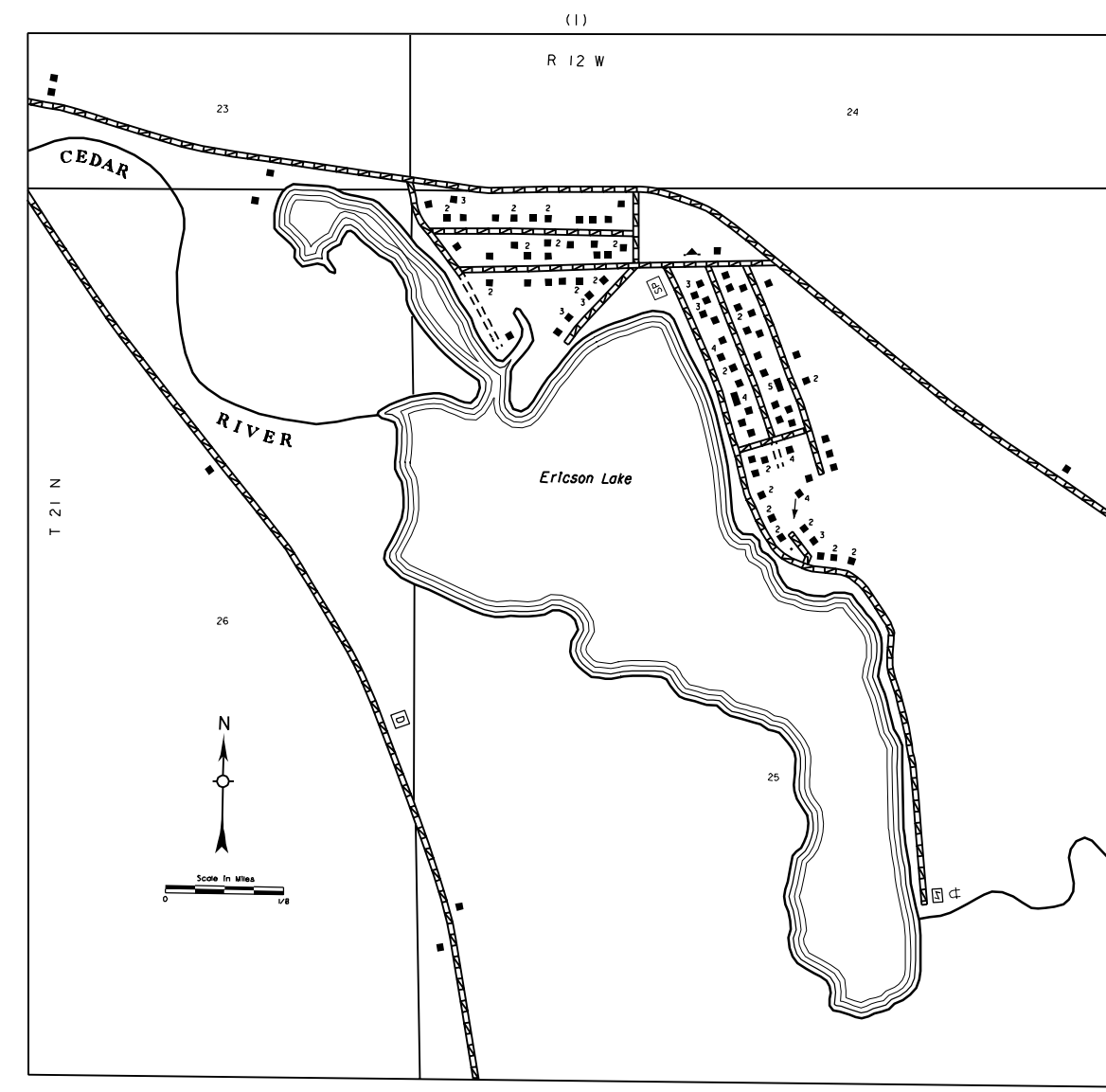

LAMBERT CONFORMAL CONIC PROJECTION
1983 NORTH AMERICAN DATUM
NEBRASKA COORDINATE SYSTEM

