

GENERAL HIGHWAY MAP WASHINGTON COUNTY NEBRASKA

PREPARED BY THE
DEPARTMENT OF ROADS
INFORMATION SYSTEMS DIVISION
IN COOPERATION WITH THE
U.S. DEPARTMENT OF TRANSPORTATION
FEDERAL HIGHWAY ADMINISTRATION

1986

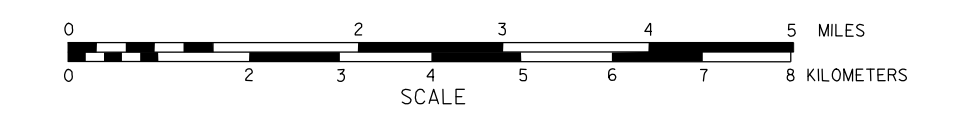

NAME	DATE	REVISION
L. GOLDSMITH	JAN. 2001	911 SYSTEM

LEGEND

- | | |
|---|---|
| Primitive Road..... | Public Use Area..... |
| Unimproved Road..... | (Comp. etc. plots, ground, swimming pool, etc.) |
| Gravel or Crushed Rock..... | Recreational Facilities..... |
| Non-Rigid Pavement (Gravel or Asphalt)..... | (Tennis, field, country club, fairground, etc.) |
| Rigid Pavement (P.C.C., Asphalt or Brick)..... | Road Area..... |
| Multiple Lane Undivided Highway..... | Ranger Station..... |
| Divided Highway..... | Fish Hatchery..... |
| Interstate Highway with Full Control of Access..... | Community Hall..... |
| State Highway with Full Control of Access..... | Correctional Institution..... |
| Interstate-Numbered Highway..... | Tourist Court or Motel..... |
| State-Numbered Highway..... | Monument-Small..... |
| (558) | Museum..... |
| (527) | Fire Station..... |
| (558) | Courthouse..... |
| (558) | Armory..... |
| (558) | Post Office..... |
| (558) | Highway Maintenance Yard..... |
| (558) | Dump Area..... |
| (558) | Sewage Disposal Plant..... |
| (558) | Water Supply Stand Pipe..... |
| (558) | Pipe Line - (Parallels)..... |
| (558) | Transmission Line..... |
| (558) | Power Plant..... |
| (558) | Power Substation..... |
| (558) | Railroad or TV Station..... |
| (558) | Pumping Station..... |
| (558) | Weight Station or Port of Entry..... |
| (558) | Commercial or Municipal Airport..... |
| (558) | Airport with Paved Runways..... |
| (558) | State Boundary..... |
| (558) | County Boundary..... |
| (558) | Township Line..... |
| (558) | Section Line..... |
| (558) | Corporate Limit Lines..... |
| (558) | Parks and Other Reservations..... |
| (558) | Boundary Limits of Area Shown in Enlargements (See enlargements for outline)..... |
| (558) | State Capital..... |
| (558) | County Seat..... |
| (558) | Other Cities and Villages..... |
| (558) | Incorporated City or Village..... |
| (558) | Points Between Which Distances Are Measured Indicated Thus..... |
| (558) | Latitude and Longitude..... |
| (558) | Nebraska Coordinate System (in thousands of feet)..... |
| (558) | Universal Transverse Mercator Grid (in thousands of feet)..... |

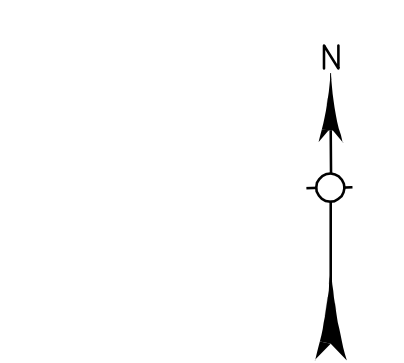
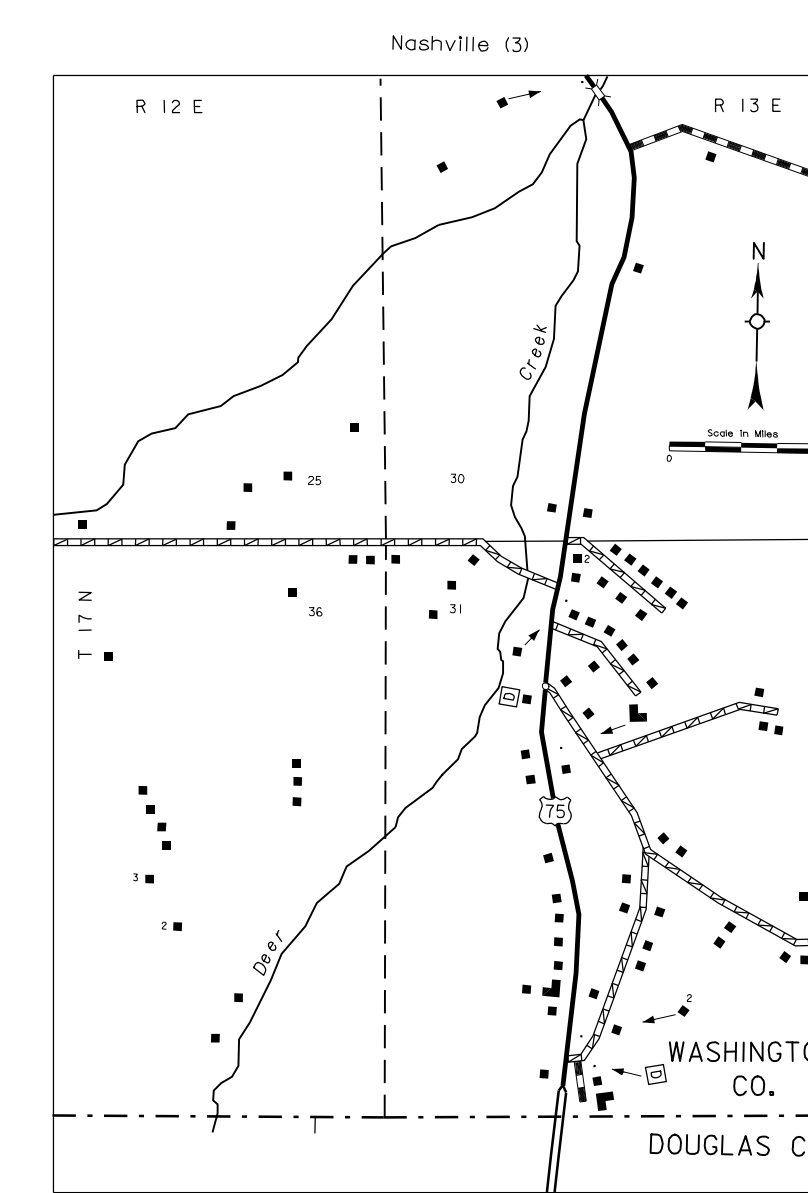
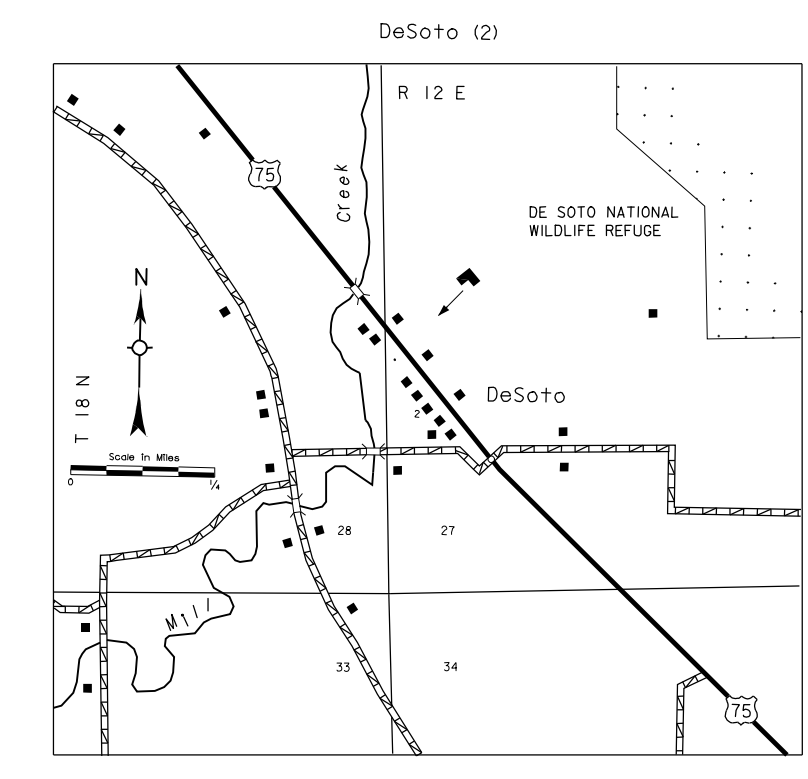
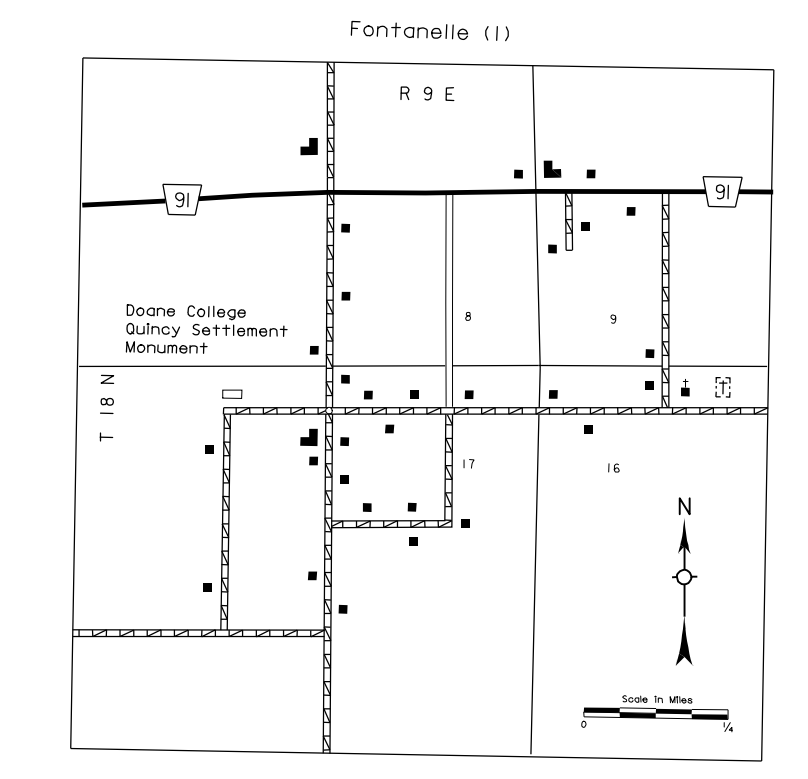

LAMBERT CONFORMAL CONIC PROJECTION
1983 NORTH AMERICAN DATUM
NEBRASKA COORDINATE SYSTEM

