

# GENERAL HIGHWAY MAP SIOUX COUNTY NEBRASKA SOUTH HALF

PREPARED BY THE  
DEPARTMENT OF ROADS  
GIS/MAPPING SECTION  
IN COOPERATION WITH THE  
U.S. DEPARTMENT OF TRANSPORTATION  
FEDERAL HIGHWAY ADMINISTRATION  
2011

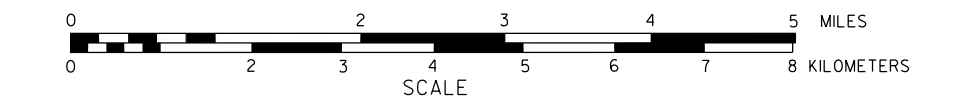

REVISION HISTORY	
DATE	REVISION
2006	HWY. SUPERINTENDENT
2011	COUNTY

## LEGEND

- Primitive Road.....
- Unimproved Road.....
- Gravel or Crusted Road.....
- Asphalt/Bituminous Surface.....
- Multiple Lane Undivided Highway.....
- Asphalt/Bituminous Surface.....
- Concrete/Brick Surface.....
- Multiple Lane Undivided Highway.....
- Concrete/Brick Surface.....
- Divided Highway with Full Control of Access.....
- Interstate Highway with Full Control of Access.....
- Sole Roads and Streets.....
- 911 NAD/Numbered Roads.....
- Interstate-Numbered Highway.....
- US-Numbered Highway.....
- State-Numbered Highway.....
- State-Numbered Highway Spur.....
- State-Numbered Highway Link.....
- Highway Reference Post Number.....
- Interstate Exit Number.....
- Wide Stream.....
- Narrow Stream.....
- Irrigation Ditch.....
- Reservoir, Pond or Lake.....
- Reservoir, With Dam.....
- Highway Bridge-Any Type (over 20' span).....
- Small Bridges-Classified Spaced.....
- General Bridge-wood, steel, concrete.....
- Arch Bridge.....
- Pedestrian Underpass.....
- Railroad Overpass.....
- Railroad Underpass.....
- Railroad.....
- Dam with Road on Top.....
- Dwelling.....
- Row of Dwellings.....
- Cemetery.....
- Church or Other Religious Institution.....
- Church with Cemetery Adjacent.....
- Hospital.....
- Business.....
- Industrial Plant.....
- Filling Station.....
- Grain Elevator.....
- Aggregate Pit.....
- Agricultural or Experimental Station.....
- Educational Institution.....
- Public Use Area.....
- Recreational Facilities.....
- Rest Area.....
- Ranger Station.....
- Fish Hatchery.....
- Community Hall.....
- Correctional Institution.....
- Tourist Court or Motel.....
- Monument-Small.....
- Museum.....
- Firestation.....
- Courthouse.....
- Armory.....
- Post Office.....
- Highway Maintenance Yard.....
- Dump Area.....
- Sewage Disposal Plant.....
- Water Supply Stand Pipe.....
- Radio or TV Station.....
- Height Station or Point of Entry.....
- Commercial or Municipal Airport.....
- Airport with Paved Runways.....
- State Boundary.....
- County Boundary.....
- Township Line.....
- Section Line.....
- Corporate Limit Lines.....
- Parks and Other Reservations.....
- Boundary Limits of Area Shown in Enclosures.....
- State Capital.....
- County Seat.....
- Other Cities and Villages.....
- Incorporated City or Village.....
- Triangulation Station.....
- Points Between Which Distances Are Measured Indicated Thus.....
- Hospital.....
- Latitude and Longitude.....

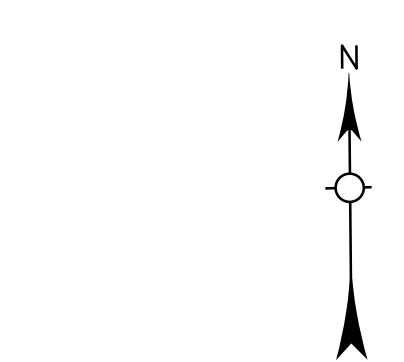
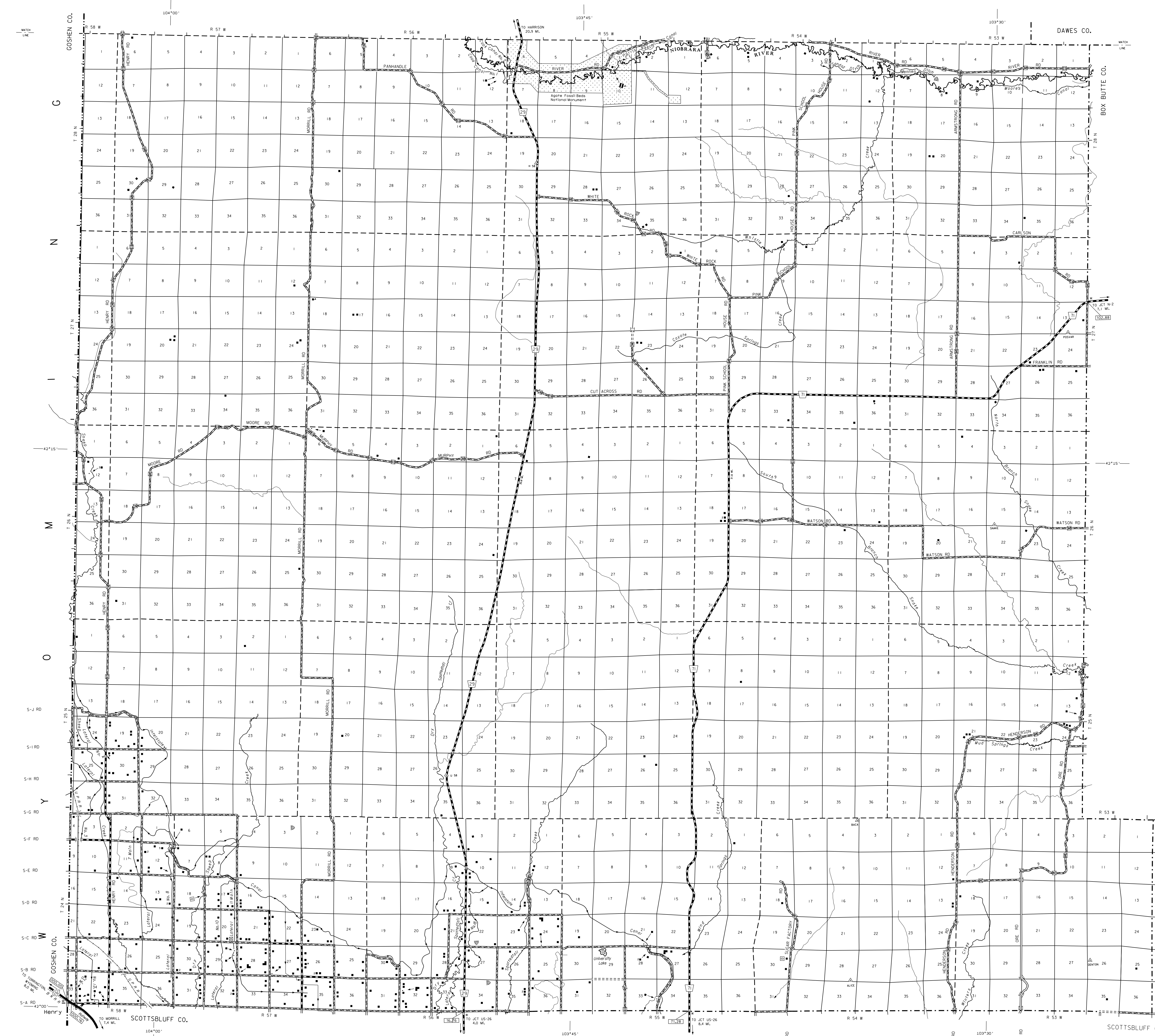

LAMBERT CONFORMAL CONIC PROJECTION  
1983 NORTH AMERICAN DATUM  
NEBRASKA COORDINATE SYSTEM

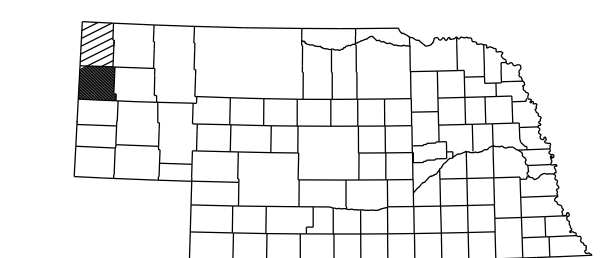

KEY TO COUNTIES

NDOR makes no warranties, guarantees, or representations for accuracy of this information and assumes no liability for errors or omissions. Please notify the Department of any errors or omissions identified in this data.

GENERAL HIGHWAY MAP

SOUTH HALF  
SIOUX COUNTY