

# GENERAL HIGHWAY MAP SEWARD COUNTY NEBRASKA

PREPARED BY THE  
**DEPARTMENT OF ROADS**  
TRANSPORTATION PLANNING DIVISION  
IN COOPERATION WITH THE  
**U.S. DEPARTMENT OF TRANSPORTATION**  
FEDERAL HIGHWAY ADMINISTRATION

1984

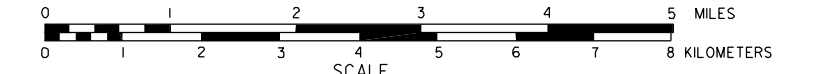

REVISION HISTORY		
NAME	DATE	REVISION
L. GOLDSMITH	JAN. 2001	911 SYSTEM

### LEGEND

- |   |   |
|---|---|
| <ul style="list-style-type: none"> <li>Primitive Road</li> <li>Unimproved Road</li> <li>Gravel or Crushed Rock</li> <li>Asphalt/Bituminous Surface</li> <li>Concrete/Brick Surface</li> <li>Multiple Lane Undivided Highway</li> <li>Divided Highway</li> <li>Interstate Highway with Full Control of Access</li> <li>Side Roads and Streets</li> <li>Interstate-Numbered Highway</li> <li>US-Numbered Highway</li> <li>State-Numbered Highway</li> <li>State-Numbered Highway Spur</li> <li>State-Numbered Highway Link</li> <li>Interstate Exit Number</li> <li>Wide Stream</li> <li>Narrow Stream</li> <li>Irrigation Ditch</li> <li>Reservoir, Pond or Lake</li> <li>Reservoir, With Dam</li> <li>Highway Bridge-Any Type, lower 20' span</li> <li>Small Bridges Closely Spaced, spacings indicate spans which bridges are grouped</li> <li>General Bridge-Steel, Concrete, Arch</li> <li>Truss Bridge</li> <li>Pedestrian Underpass</li> <li>Railroad Overpass</li> <li>Railroad Underpass</li> <li>Railroad</li> <li>Dam with Road on Top</li> <li>Cattle Guard</li> <li>Dwelling</li> <li>Row of Dwellings</li> <li>Cemetery</li> <li>Church or Other Religious Institution</li> <li>Church with Cemetery Adjacent</li> <li>Hospital</li> <li>Business</li> <li>Industrial Plant</li> <li>Filling Station</li> <li>Grain Elevator</li> <li>Aggregate Pit</li> <li>Agricultural Experimental Station</li> <li>Educational Institutions</li> </ul> | <ul style="list-style-type: none"> <li>Public Use Area</li> <li>Recreational Facilities</li> <li>Rest Area</li> <li>Ranger Station</li> <li>Fish Hatchery</li> <li>Community Hall</li> <li>Correctional Institution</li> <li>Tourist Court or Motel</li> <li>Monument-Small</li> <li>Museum</li> <li>Firestation</li> <li>Courthouse</li> <li>Post Office</li> <li>Highway Maintenance Yard</li> <li>Dump Area</li> <li>Sewage Disposal Plant</li> <li>Water Supply Stand Pipe</li> <li>Pipe Line</li> <li>Transmission Line</li> <li>Power Station</li> <li>Radio or TV Station</li> <li>Pumping Station</li> <li>Weight Station or Port of Entry</li> <li>Commercial or Municipal Airport</li> <li>Airport with Paved Runways</li> <li>State Boundary</li> <li>County Boundary</li> <li>Township Line</li> <li>Section Line</li> <li>Corporate Limit Lines</li> <li>Parks and Other Reservations</li> <li>Boundary Limits of Area Shown in Enclosures (see enclosures for culture)</li> <li>State Capital</li> <li>County Seat</li> <li>Other Cities and Villages</li> <li>Incorporated City or Village</li> <li>Triangulation Station</li> <li>Points Between Which Distances Are Measured indicated Thus</li> <li>Latitude and Longitude</li> <li>Nebraska Coordinate System in thousands of feet</li> <li>Universal Transverse Mercator Grid in thousands of feet</li> </ul> |
|---|---|

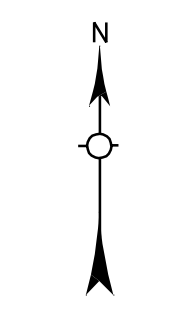
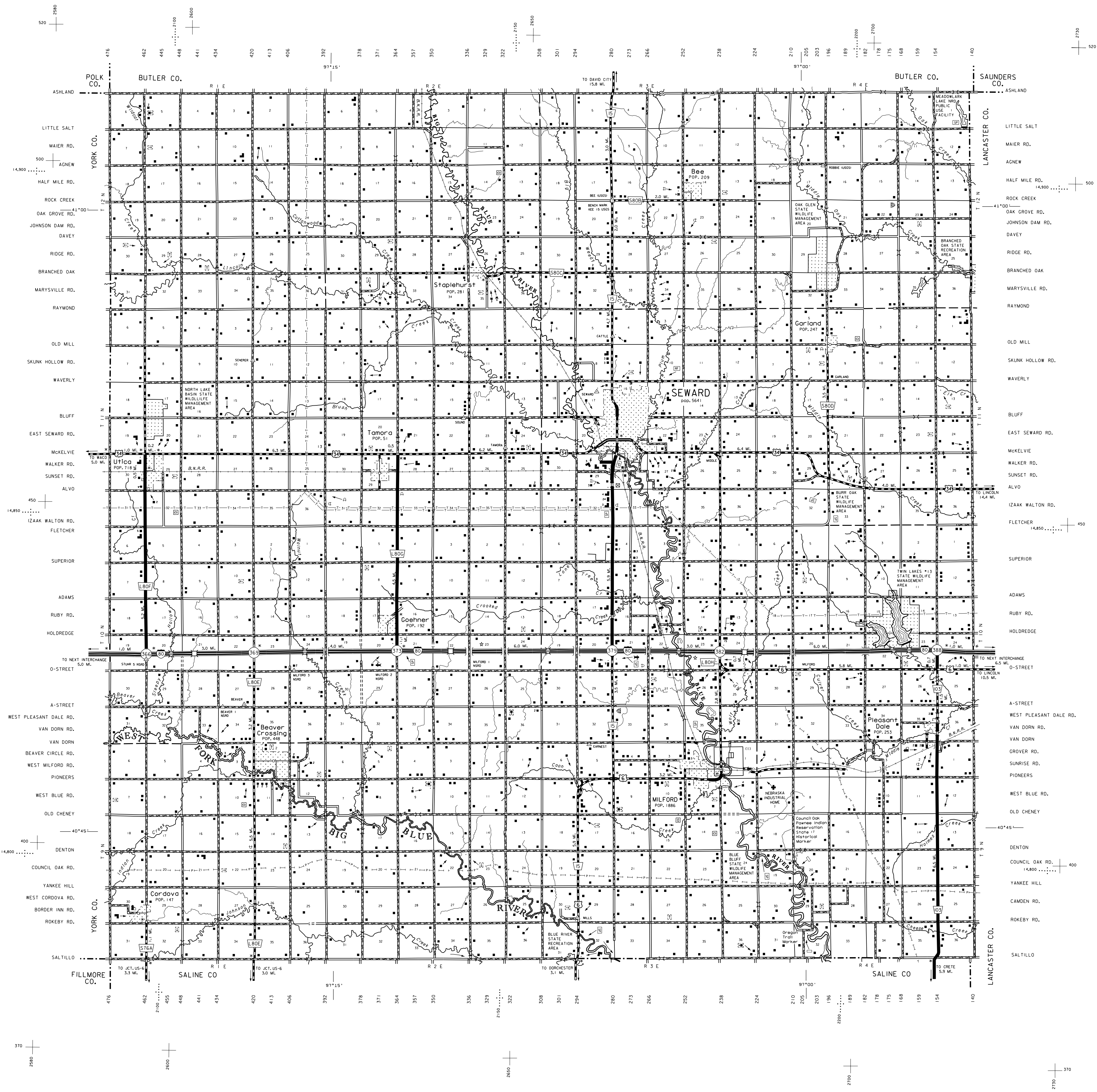
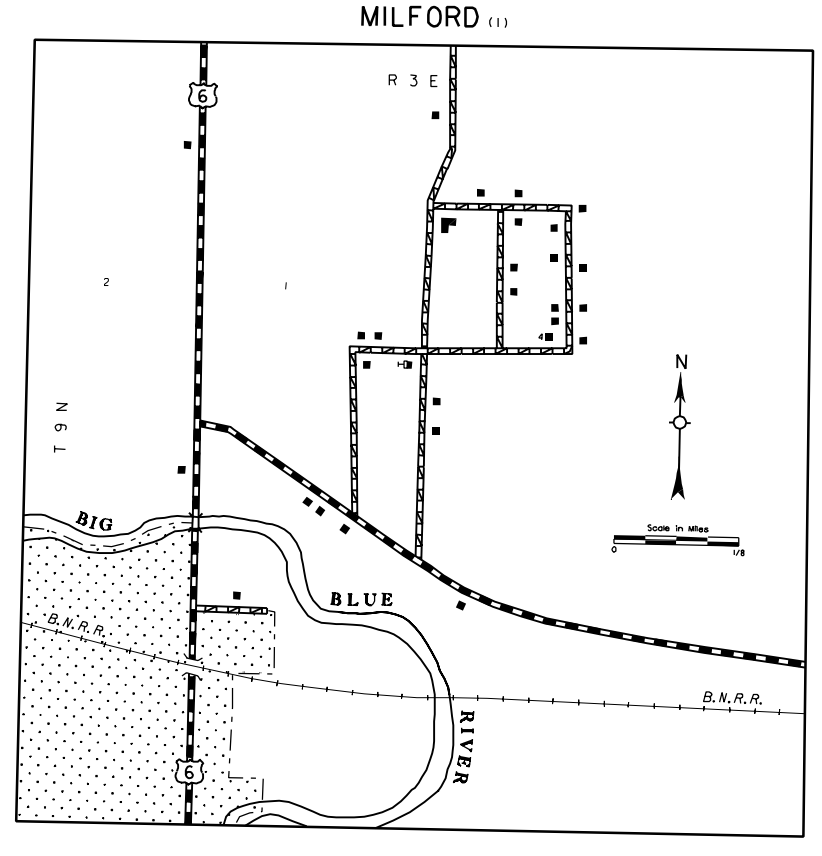
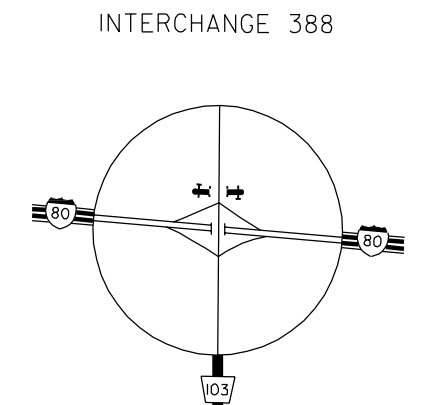
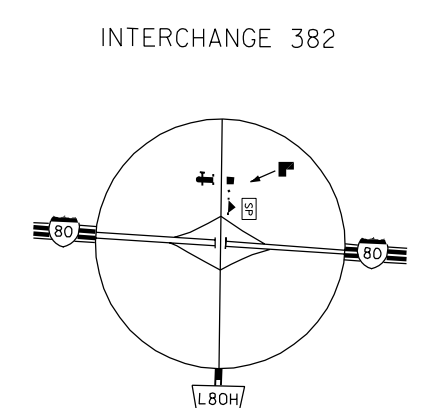
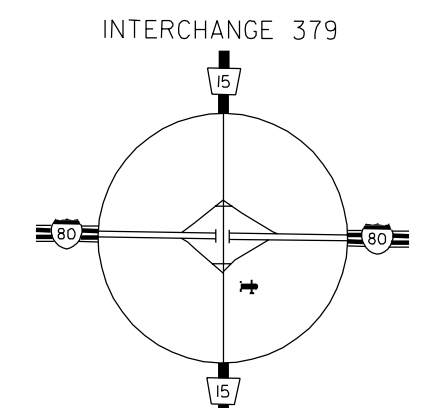
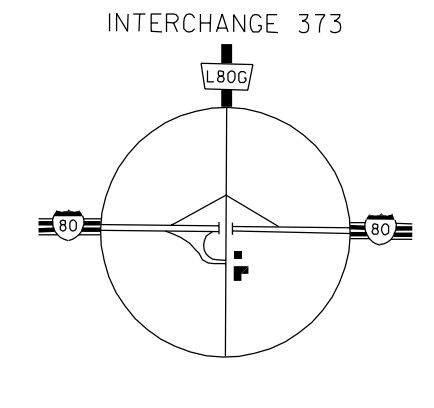
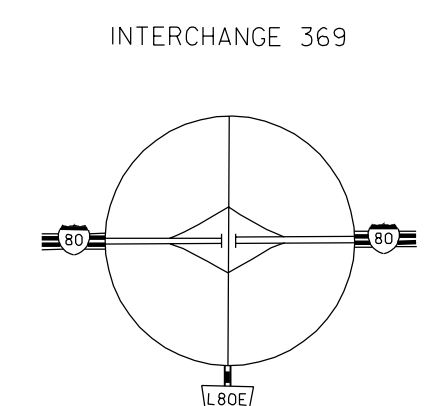
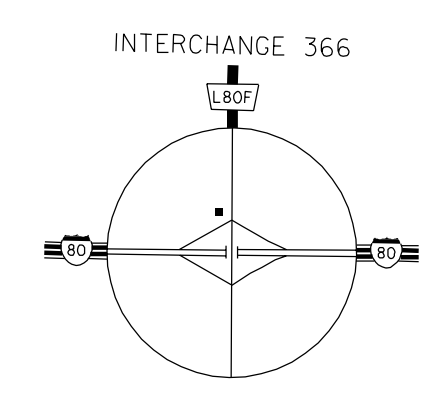

LAMBERT CONFORMAL CONIC PROJECTION  
1927 NORTH AMERICAN DATUM  
NEBRASKA COORDINATE SYSTEM-SOUTH ZONE

