

GENERAL HIGHWAY MAP KEYA PAHA COUNTY NEBRASKA

PREPARED BY THE
DEPARTMENT OF ROADS
INFORMATION SYSTEMS DIVISION
IN COOPERATION WITH THE
U.S. DEPARTMENT OF TRANSPORTATION
FEDERAL HIGHWAY ADMINISTRATION
1988

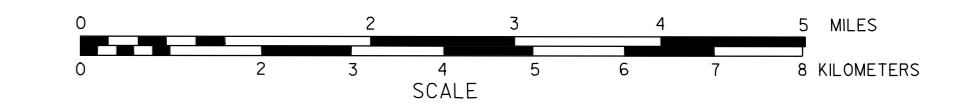

NAME	DATE	REVISION HISTORY
G. WILLIAMS	MARCH 2003	N-12 & US-183 PAVEMENT NR SPRINGVIEW

LEGEND

- | | |
|---|---|
| Primitive Road..... | Public Use Area..... |
| Unimproved Road..... | Recreational Facilities..... |
| Gravel or Crushed Rock..... | Rest Area..... |
| Non Rigid Pavement (Gr. or Asph.)..... | Ranger Station..... |
| Rigid Pavement (P.C., Asph. or Brk.)..... | Flan Hatchery..... |
| Multiple Lane Undivided Highway..... | Community Hall..... |
| Divided Highway..... | Correctional Institution..... |
| Interstate Highway with Full Control of Access..... | Tourist Court or Motel..... |
| Interstate-Numbered Highway..... | Monument-Small..... |
| US-Numbered Highway..... | Museum..... |
| State-Numbered Highway..... | Firestation..... |
| State-Numbered Highway Spur..... | Courthouse..... |
| State-Numbered Highway Link..... | Post Office..... |
| Interstate Exit Number..... | Highway Maintenance Yard..... |
| Wide Stream..... | Dump Area..... |
| Narrow Stream..... | Sewage Disposal Plant..... |
| Irrigation Ditch..... | Water Supply Stand Pipe..... |
| Reservoir, Pond or Lake..... | Pipe Line - Pressure..... |
| Reservoir, With Dam..... | Transmission Line..... |
| Highway Bridge Any Type..... | Power Plant..... |
| Small Bridges-Closely Spaced..... | Power Substation..... |
| Small Bridges-Widely Spaced..... | Radio or TV Station..... |
| General Bridge..... | Pumping Station..... |
| Arch Bridge..... | Signal Station or Part of Entry..... |
| Truss Bridge..... | Commercial or Municipal Airport..... |
| Pedestrian Overpass..... | Airport with Paved Runways..... |
| Pedestrian Underpass..... | State Boundary..... |
| Railroad Overpass..... | County Boundary..... |
| Railroad Underpass..... | Township Line..... |
| Dam with Road on Top..... | Section Line..... |
| Dwelling..... | Corporate Limit Lines..... |
| Row of Dwellings..... | Parks and Other Reservations..... |
| Cemetery..... | Boundary Limits of Area Shown in Editor's Note..... |
| Church or Other Religious Institution..... | State Capitol..... |
| Church with Cemetery Adjacent..... | County Seat..... |
| Hospital..... | Other Cities and Villages..... |
| Business..... | Incorporated City or Village..... |
| Industrial Plant..... | Trangulation Station..... |
| Filling Station..... | Points Between Which Distances Are Measured Indicated True..... |
| Grain Elevator..... | Latitude and Longitude..... |
| Aggregate Pits..... | Nebraska Coordinate System..... |
| Agricultural Experimental Station..... | Universal Transverse Mercator Grid..... |
| Educational Institutions..... | |

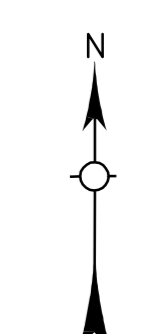
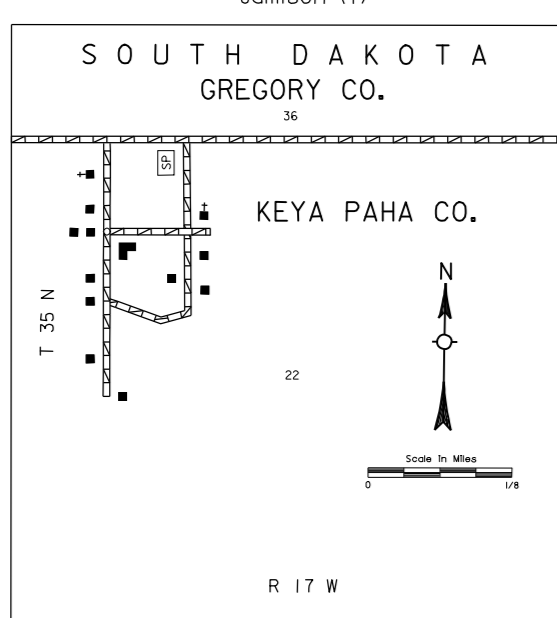
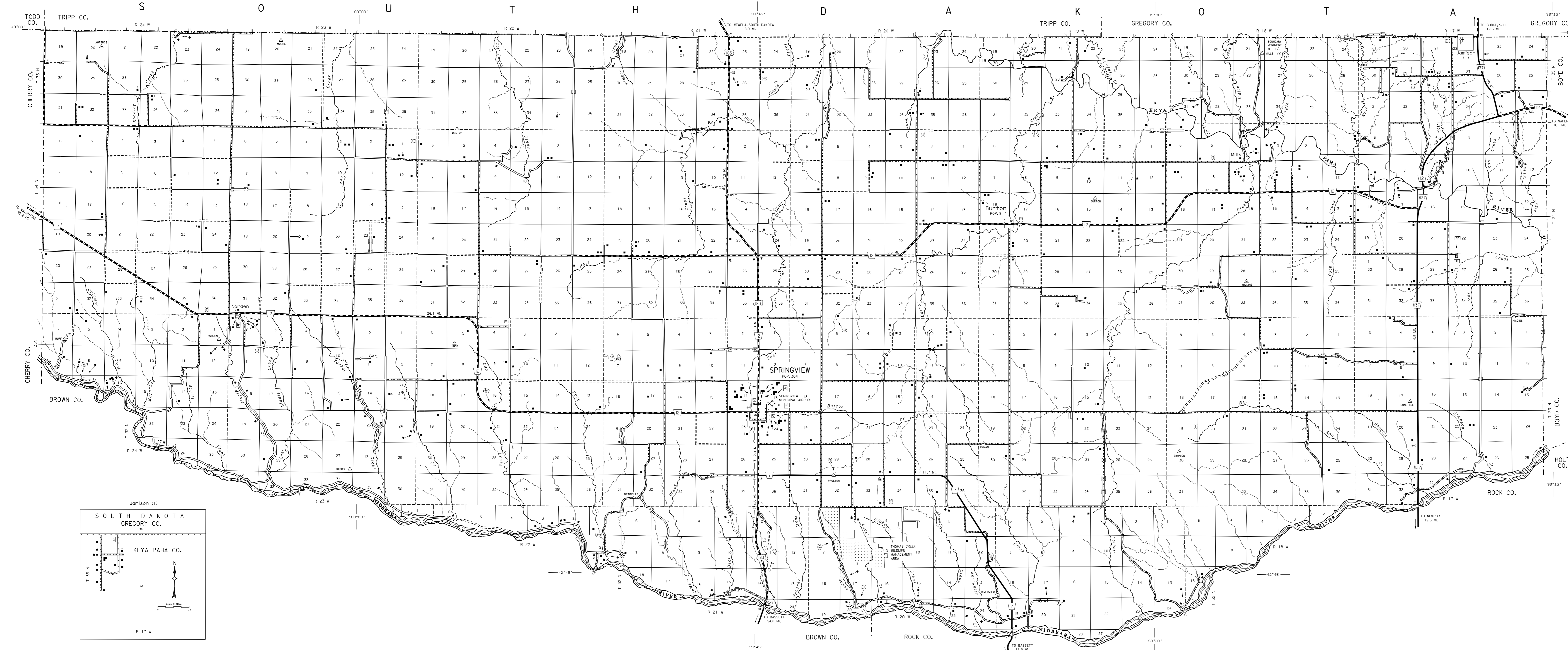

LAMBERT CONFORMAL CONIC PROJECTION
1983 NORTH AMERICAN DATUM
NEBRASKA COORDINATE SYSTEM

