

# GENERAL HIGHWAY MAP JOHNSON COUNTY NEBRASKA

PREPARED BY THE  
DEPARTMENT OF ROADS  
INFORMATION SYSTEMS DIVISION  
IN COOPERATION WITH THE  
U.S. DEPARTMENT OF TRANSPORTATION  
FEDERAL HIGHWAY ADMINISTRATION

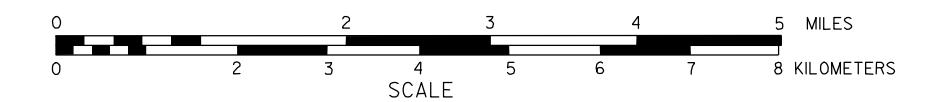

INVENTORY DATE:  
1995

REVISION HISTORY		
NAME	DATE	REVISION
K. FLOWERS	1997	COUNTY
G. WILLIAMS	OCTOBER 2001	GIS/CS
L. GODSMITH	AUGUST 2003	911 SYSTEM
G. WILLIAMS	MARCH 2004	REP. POSTS

### LEGEND

- |   |  |
|---|--|
| Primitive Road  | Aggregate Pft.   |
| Unimproved Road   | Agricultural Experimental Station  |
| Gravel or Crushed Rock  | Educational Institutions   |
| Asphalt/Bituminous Surface  | Public Use Area  |
| Concrete/Block Surface  | Recreational Facilities  |
| Multiple Lane Unimproved Highway  | Rest Area  |
| Divided Highway   | Ranger Station   |
| Interstate Highway with Full Control of Access  | Fish Hatchery  |
| State Roads and Streets   | Community Hall   |
| 911 NAMED/NUMBERED ROADS - ADAMS ROAD   | Correctional Institution   |
| Interstate-Numbered Highway   | Tourist Court or Motel   |
| US-Numbered Highway   | Monument-Small   |
| State-Numbered Highway  | Museum   |
| State-Numbered Highway Spur   | Firestation  |
| State-Numbered Highway Link   | Courthouse   |
| Highway Reference Post Number   | Armory   |
| Interstate Exit Number  | Post Office  |
| Wide Stream   | Highway Maintenance Yard   |
| Narrow Stream   | Dump Area  |
| Irrigation Ditch  | Sewage Disposal Plant  |
| Reservoir, Pond or Lake   | Water Supply Stand Pipe  |
| Reservoir, With Dam   | Pipe Line - Parastatic   |
| Highway Bridge-Any Type (over 20 spans)   | Transmission Line  |
| Small Bridges-Closely Spaced (Instruments indicate limits within which bridges are grouped) | Power Plant  |
| General Bridge (in wood, steel, concrete)   | Power Substation   |
| Arch Bridge   | Radio or TV Station  |
| Truss Bridge  | Pumping Station  |
| Pedestrian Underpass  | Weight Station or Part of Entry  |
| Pedestrian Overpass   | Commercial or Municipal Airport  |
| Railroad Overpass   | Airport with Paved Runways   |
| Railroad Underpass  | State Boundary   |
| Railroad  | County Boundary  |
| Dam with Road on Top  | Township Line  |
| Cattle Guard  | Section Line   |
| Dwelling  | Corporate Limit Lines  |
| Row of Dwellings  | Parks and Other Reservations   |
| Cemetery  | Boundary Limits of Area Shown in Enclosures (see enclosures for details) |
| Church or Other Religious Institution   | State Capital  |
| Church with Cemetery Adjacent   | County Seat  |
| Hospital  | Other Cities and Villages  |
| Business  | Incorporated City or Village   |
| Industrial Plant  | Triangulation Station  |
| Filling Station   | Points Between Which Distances Are Measured Indicated Thus               |
| Grain Elevator  | Latitude and Longitude   |

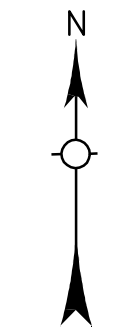
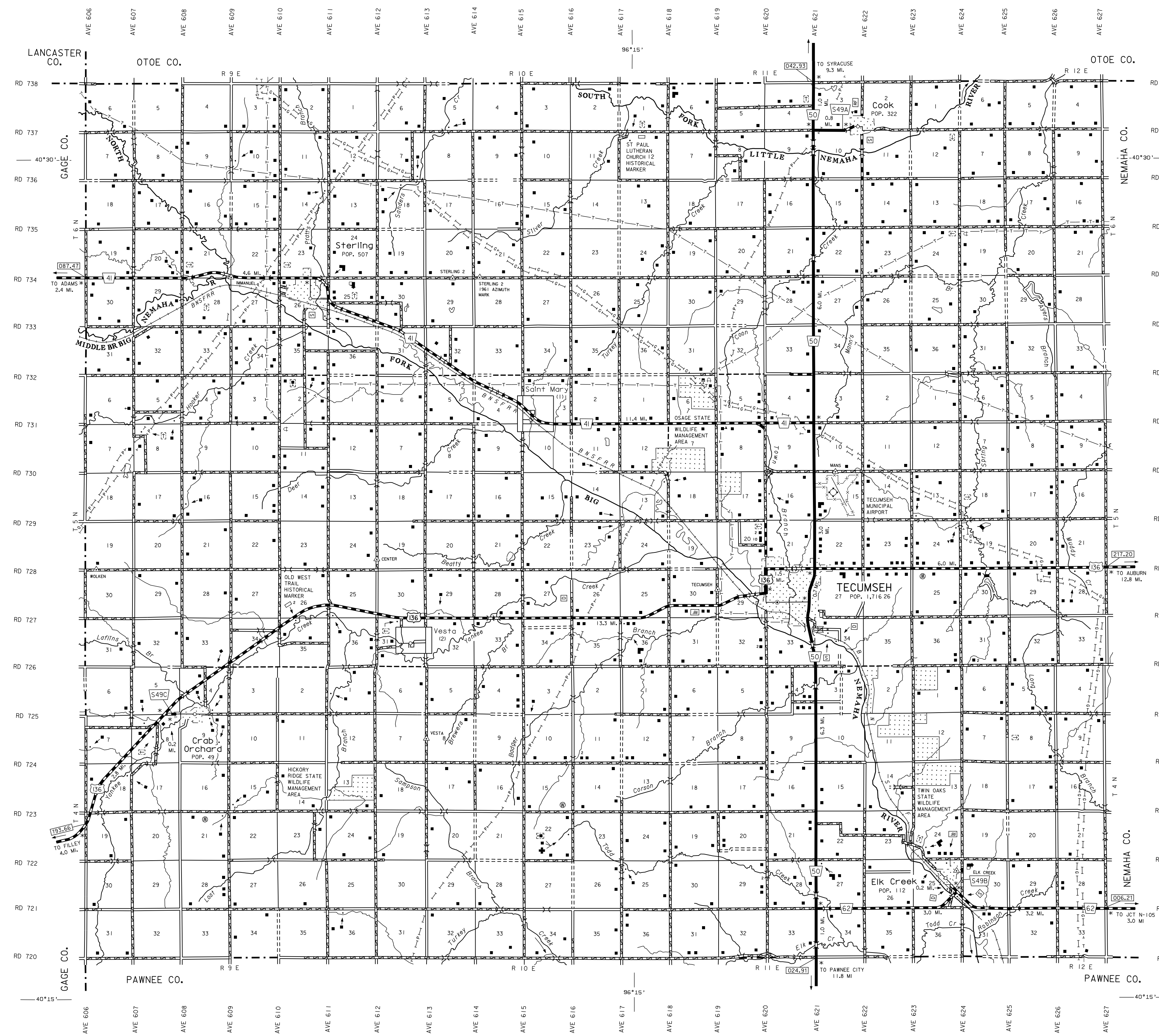
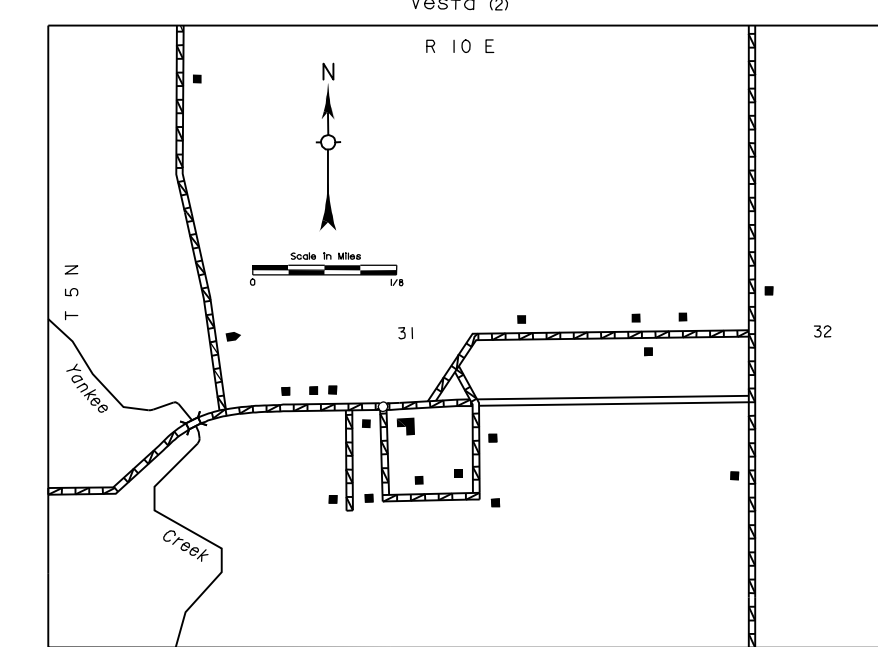
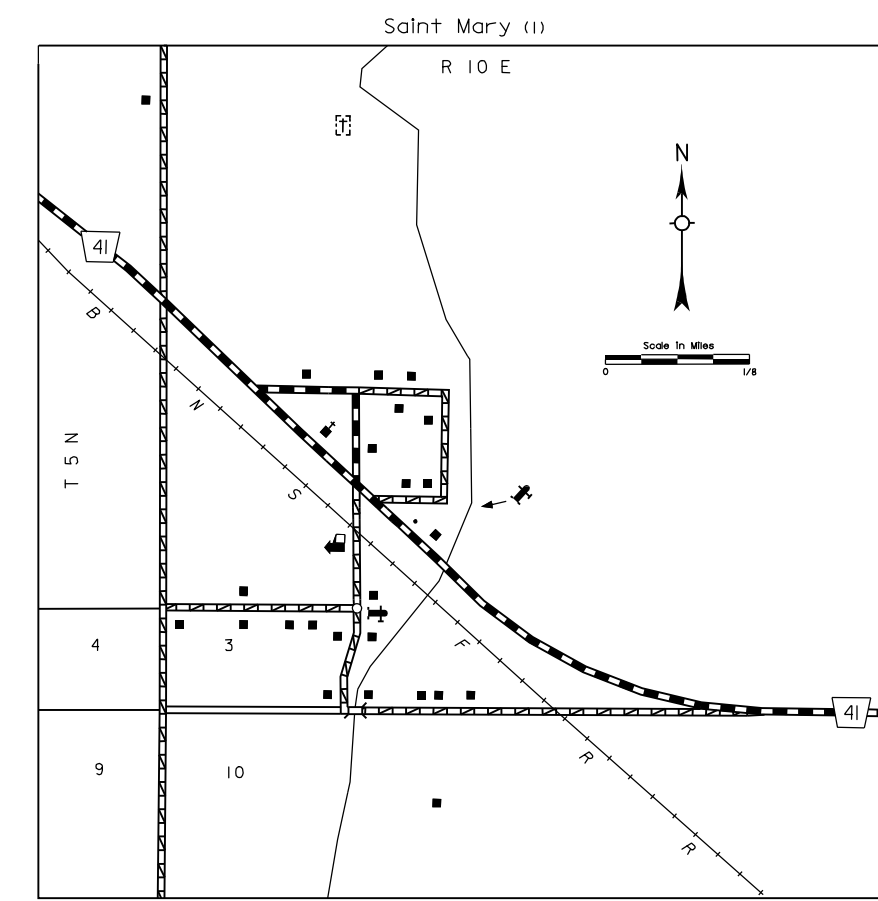

LAMBERT CONFORMAL CONIC PROJECTION  
1983 NORTH AMERICAN DATUM  
NEBRASKA COORDINATE SYSTEM

