

GENERAL HIGHWAY MAP DEUEL COUNTY NEBRASKA

PREPARED BY THE
DEPARTMENT OF ROADS
INFORMATION SYSTEMS DIVISION
IN COOPERATION WITH THE
U.S. DEPARTMENT OF TRANSPORTATION
FEDERAL HIGHWAY ADMINISTRATION

1984

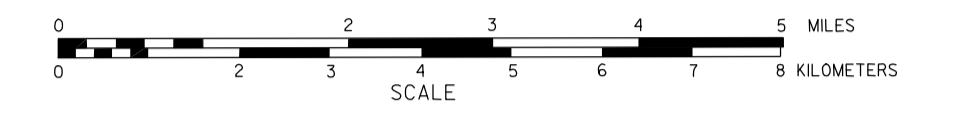

NAME	REVISION DATE	REVISION
L. GOLDSMITH	OCT. 2000	911 SYSTEM
G. WILLIAMS	SEPT. 2002	US 138 RE-ALIGN

LEGEND

- | | |
|--|--|
| Primitive Road | Public Use Area |
| Unimproved Road | Recreational Facilities |
| Gravel or Crushed Rock | Road |
| Asphalt/Bituminous Surface | Ranger Station |
| Concrete/Brick Surface | Fish Hatchery |
| Multiple Lane Undivided Highway | Community Hall |
| Divided Highway | Correctional Institution |
| Interstate Highway with Full Control of Access | Side Roads and Streets |
| Interstate Highway | Tourist Court or Motel |
| US-Numbered Highway | Museum |
| State-Numbered Highway | Fire Station |
| State-Numbered Highway Spur | Courthouse |
| State-Numbered Highway Link | Armory |
| Interstate Exit Number | Post Office |
| Highway Maintenance Yard | Highway Maintenance Yard |
| Dump Area | Dump Area |
| Sewage Disposal Plant | Sewage Disposal Plant |
| Water Supply Stand Pipe | Water Supply Stand Pipe |
| Transmission Line | Transmission Line |
| Power Plant | Power Plant |
| Power Substation | Power Substation |
| Radio or TV Station | Radio or TV Station |
| Pumping Station | Pumping Station |
| Weight Station or Part of Entry | Weight Station or Part of Entry |
| Commercial or Municipal Airport | Commercial or Municipal Airport |
| Alphabet with Paved Runways | Alphabet with Paved Runways |
| State Boundary | State Boundary |
| County Boundary | County Boundary |
| Township Line | Township Line |
| Section Line | Section Line |
| Corporate Limit Lines | Corporate Limit Lines |
| Parks and Other Reservations | Parks and Other Reservations |
| Boundary Limits of Area Shown in Enclosures | Boundary Limits of Area Shown in Enclosures |
| State Capital | State Capital |
| County Seat | County Seat |
| Other Cities and Villages | Other Cities and Villages |
| Incorporated City or Village | Incorporated City or Village |
| Triangulation Station | Triangulation Station |
| Points Between Which Distances Are Measured Indicated Thus | Points Between Which Distances Are Measured Indicated Thus |
| Latitude and Longitude | Latitude and Longitude |
| Nebraska Coordinate System | Nebraska Coordinate System |
| Grid Elevations | Grid Elevations |
| Agricultural Experimental Station | Agricultural Experimental Station |
| Educational Institutions | Educational Institutions |

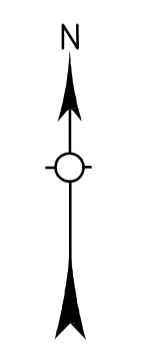
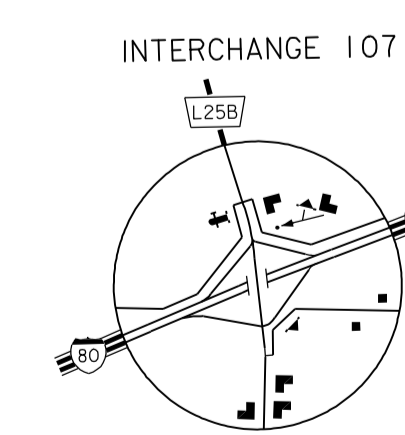
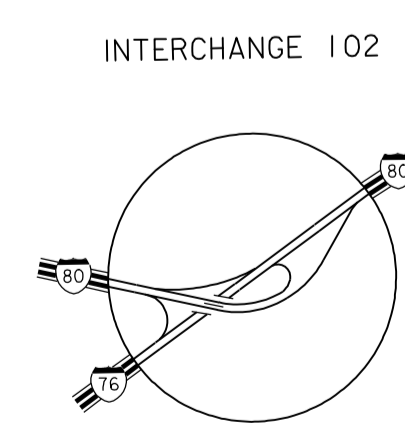
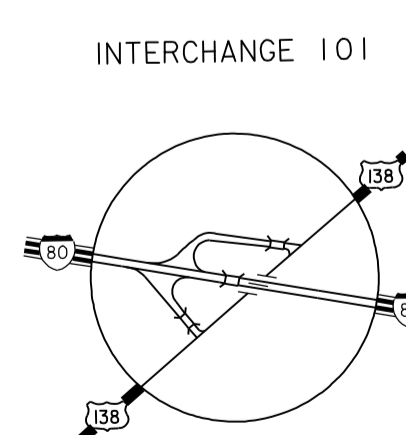
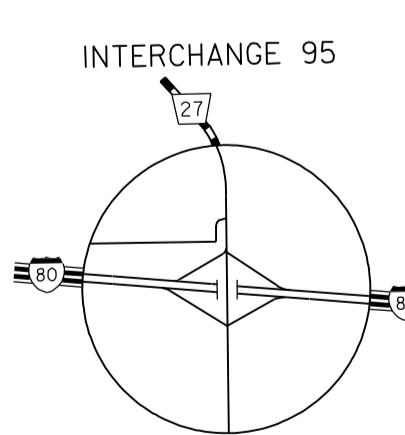
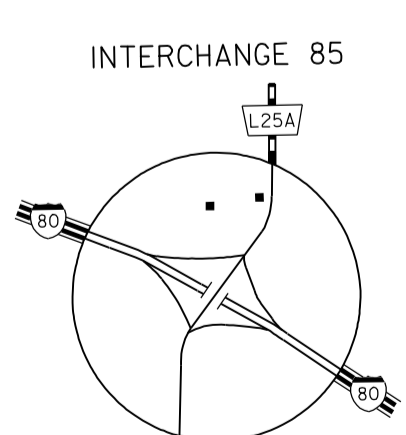
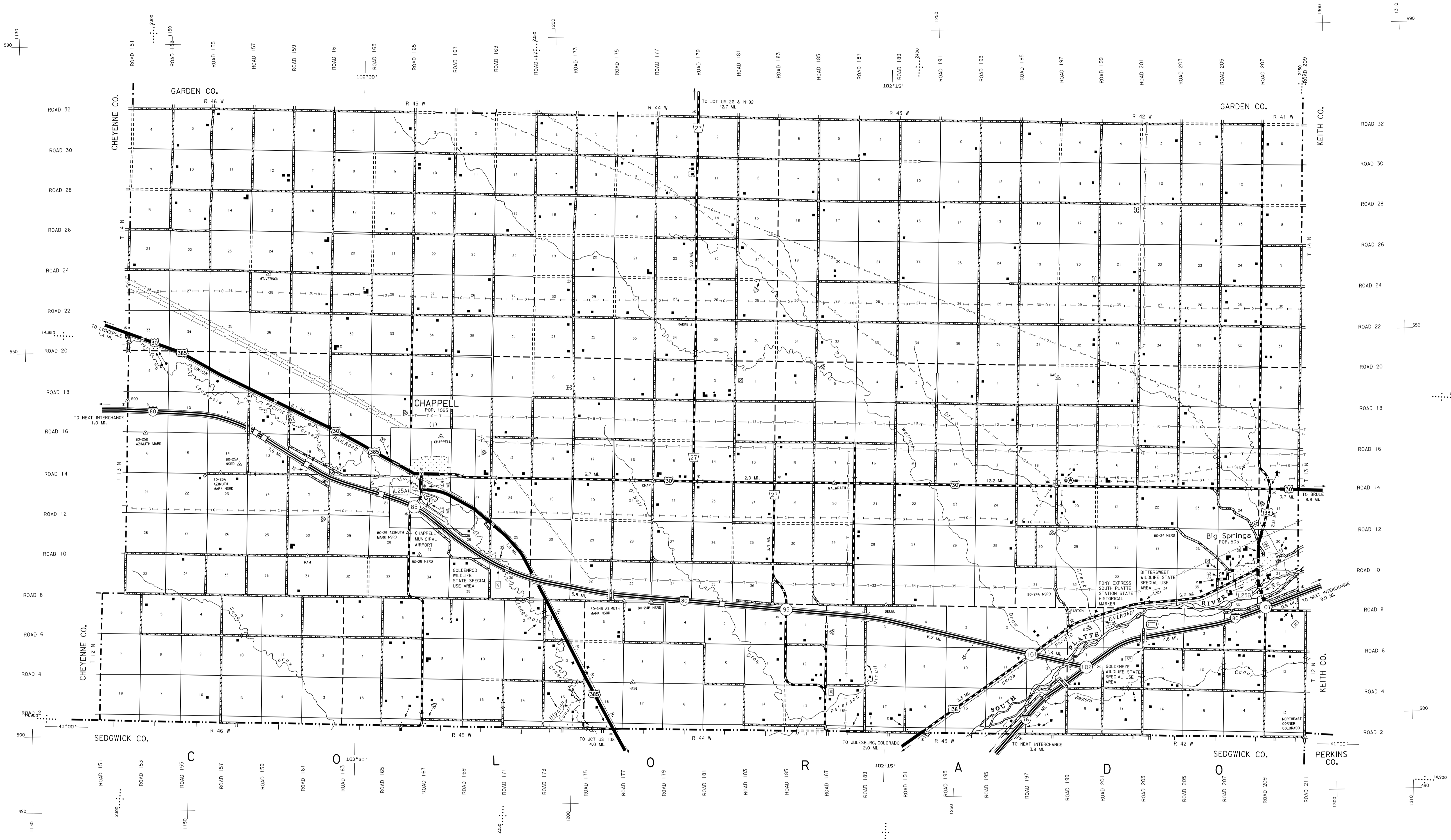
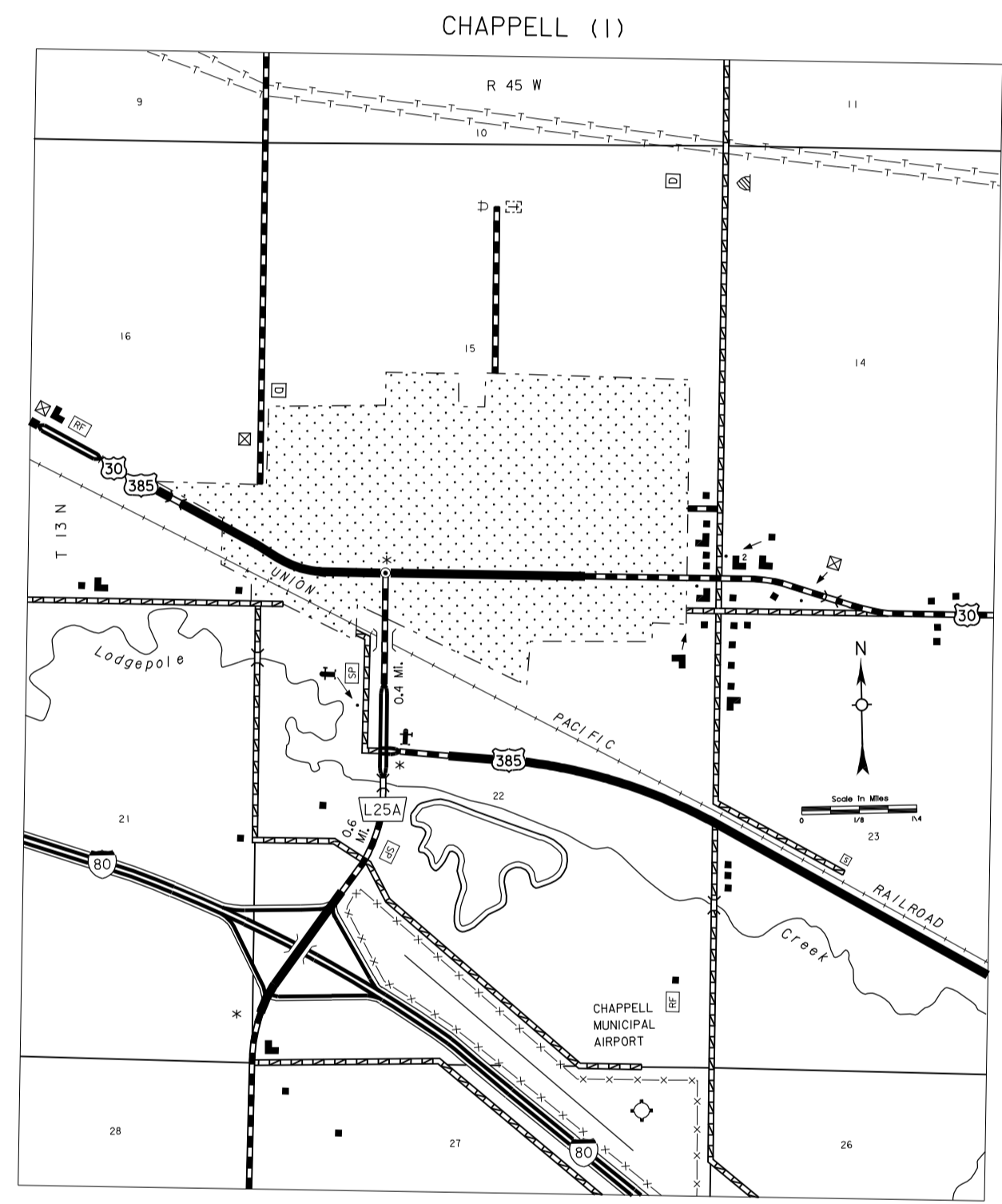

LAMBERT CONFORMAL CONIC PROJECTION
1983 NORTH AMERICAN DATUM
NEBRASKA COORDINATE SYSTEM

