

GENERAL HIGHWAY MAP CHERRY COUNTY SOUTHWEST QUARTER NEBRASKA

PREPARED BY THE
DEPARTMENT OF ROADS
TRANSPORTATION PLANNING DIVISION
IN COOPERATION WITH THE
U.S. DEPARTMENT OF TRANSPORTATION
FEDERAL HIGHWAY ADMINISTRATION
1989

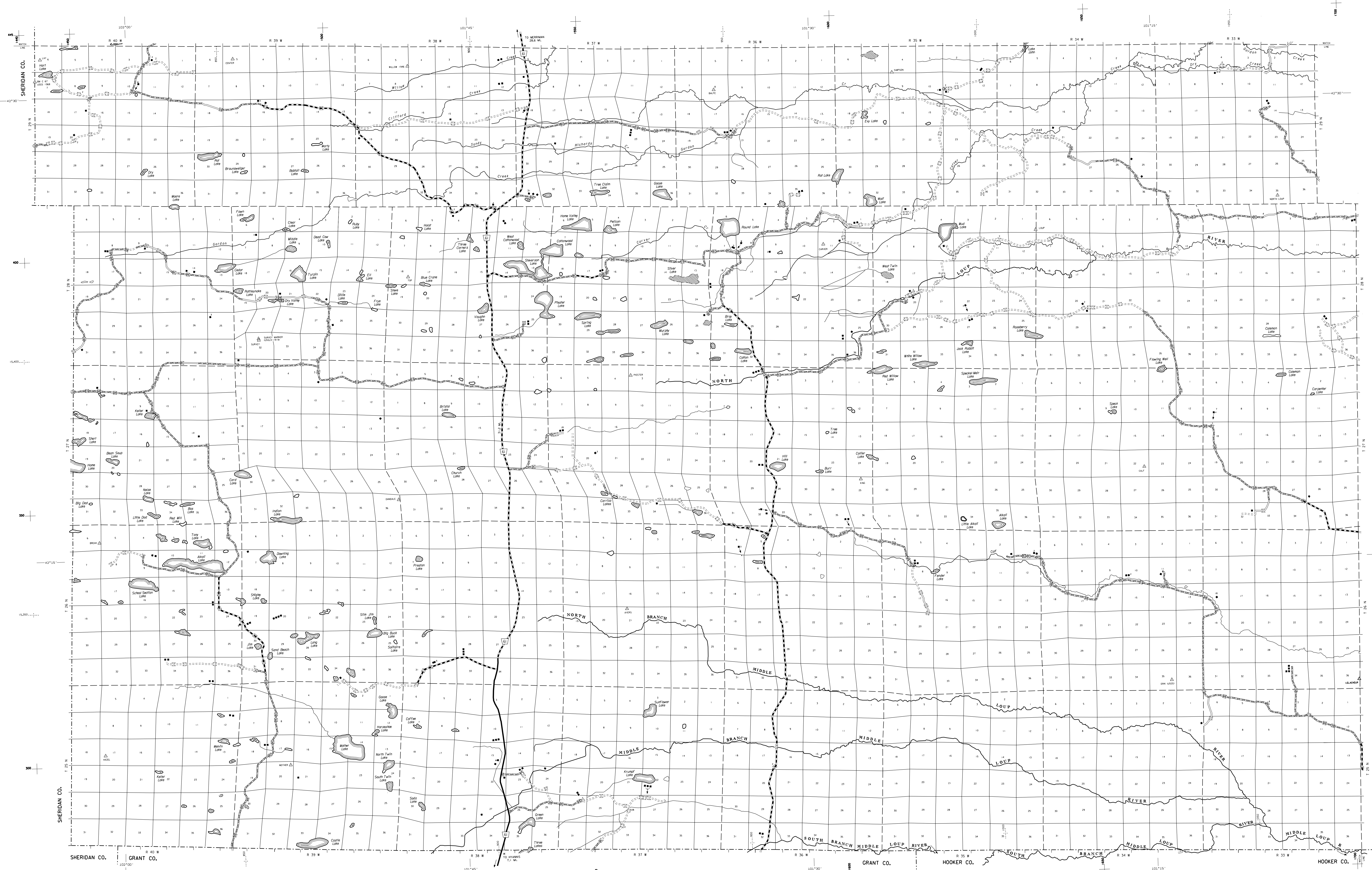
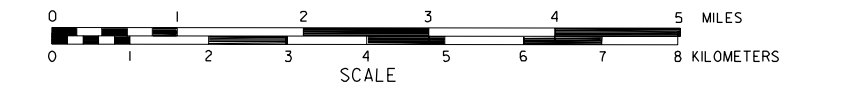

LEGEND

- | | |
|--|--|
| Primitive Road | Public Use Area |
| Unimproved Road | Recreational Facilities |
| Gravel or Crushed Rock | Non-Rigid Pavement (e.g., asphalt, concrete) |
| Non-Rigid Pavement (e.g., asphalt, concrete) | Ranger Station |
| Rigid Pavement (e.g., asphalt, concrete) | Fish Hatchery |
| Multiple Lane Undivided Highway | Community Hall |
| Divided Highway | Correctional Institution |
| Interstate Highway with Full Control of Access | Tourist Court or Motel |
| Side Roads and Streets | Monument - Small |
| Interstate-Numbered Highway | Museum |
| US-Numbered Highway | Firestation |
| State-Numbered Highway | Courthouse |
| State-Numbered Highway Spur | Armory |
| State-Numbered Highway Link | Post Office |
| Interstate Exit Number | Highway Maintenance Yard |
| Wide Stream | Dump Area |
| Narrow Stream | Sewage Disposal Plant |
| Irrigation Ditch | Water Supply Stand Pipe |
| Reservoir, Pond or Lake | Pipe Line |
| Reservoir with Dam | Transmission Line |
| Highway Bridge - Any Type | Power Plant |
| Small Bridges - Closely Spaced | Power Substation |
| Large Bridges - Widely Spaced | Radio or TV Station |
| General Bridge - Road, Stream, Concrete | Pumping Station |
| Arch Bridge | Weight Station or Part of Entry |
| Truss Bridge | Commercial or Municipal Airport |
| Pedestrian Underpass | Airport with Paved Runways |
| Pedestrian Overpass | State Boundary |
| Railroad Overpass | County Boundary |
| Railroad Underpass | Township Line |
| Dom with Road on Top | Section Line |
| Dwelling | Corporate Limit Line |
| Row of Dwellings | Parks and Other Reservations |
| Cemetery | Boundary Limits of Area Shown in Other Quarter's Map |
| Church or Other Religious Institution | State Capital |
| Church with Cemetery Adjacent | County Seat |
| Hospital | Other Cities and Villages |
| Business | Incorporated City or Village |
| Industrial Plant | Triangulation Station |
| Filling Station | Points Between Which Distances Are Measured Indicated Thus |
| Grain Elevator | Latitude and Longitude |
| Aggregate Pit | Nebraska Coordinate System |
| Agricultural Experimental Station | Universal Transverse Mercator Grid |
| Educational Institutions | |

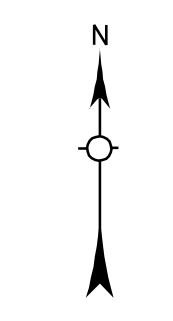

LAMBERT CONFORMAL CONIC PROJECTION
1927 NORTH AMERICAN DATUM
NEBRASKA COORDINATE SYSTEM-NORTH ZONE

