

# GENERAL HIGHWAY MAP CHASE COUNTY NEBRASKA

PREPARED BY THE  
DEPARTMENT OF ROADS  
GIS/MAPPING SECTION  
IN COOPERATION WITH THE

U.S. DEPARTMENT OF TRANSPORTATION  
FEDERAL HIGHWAY ADMINISTRATION  
2011

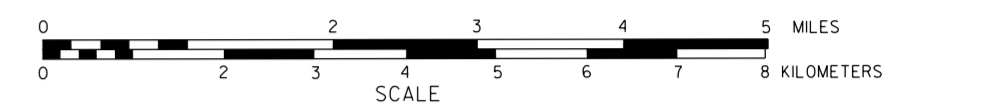

DATE	REVISION
DEC. 2005	'91 SYSTEM
MAY 2007	HW SUPERINTENDENT
JUNE 2010	COUNTY MAP

### LEGEND

- Primitive Road.....
- Unimproved Road.....
- Gravel or Crushed Rock.....
- Asphalt Bituminous Surface.....
- Multiple Lane Unimproved Highway.....
- Asphalt Bituminous Surface.....
- Concrete/Brick Surface.....
- Multiple Lane Unimproved Highway.....
- Concrete/Brick Surface.....
- Divided Highway.....
- Interstate Highway with Full Control of Access.....
- Side Roads and Streets.....
- 911 NAMED/NUMBERED ROADS.....
- Interstate Highway.....
- US-Numbered Highway.....
- State-Numbered Highway.....
- State-Numbered Highway Spur.....
- State-Numbered Highway Line.....
- Highway Reference Post Number.....
- Interstate Exit Number.....
- Wide Stream.....
- Narrow Stream.....
- Irrigation Ditch.....
- Reservoir, Pond or Lake.....
- Reservoir, With Dam.....
- Highway Bridge-Any Type.....
- Lower 20' Span.....
- Small Bridges-Closely Spaced.....
- Large Bridges-Closely Spaced.....
- General Bridge.....
- Arch Bridge.....
- Truss Bridge.....
- Pedestrian Overpass.....
- Railroad Overpass.....
- Railroad.....
- Dam with Road on Top.....
- Cattle Guard.....
- Dwelling.....
- Row of Dwellings.....
- Cemetery.....
- Church or Other Religious Institution.....
- Church with Cemetery Adjacent.....
- Hospital.....
- Industrial Plant.....
- Filling Station.....
- Grain Elevator.....
- Aggregate Pit.....
- Agricultural Experimental Station.....
- Educational Institutions.....
- Public Use Area.....
- Recreation Facilities.....
- Rest Area.....
- Ranger Station.....
- Fish Hatchery.....
- Community Hall.....
- Correctional Institution.....
- Tourist Court or Motel.....
- Museum.....
- Firestation.....
- Courthouse.....
- Armory.....
- Post Office.....
- Highway Maintenance Yard.....
- Dump Area.....
- Sewage Disposal Plant.....
- Water Supply Stand Pipe.....
- Radio or TV Station.....
- Weight Station or Port of Entry.....
- Commercial or Municipal Airport.....
- Airport with Paved Runways.....
- State Boundary.....
- County Boundary.....
- Township Line.....
- Section Line.....
- Corporate Limit Lines.....
- Parks and Other Reservations.....
- Boundary Limits of Area Shown in Enclosures Use Enclosures for Aerial.....
- State Capitol.....
- County Seat.....
- Other Cities and Villages.....
- Incorporated City or Village.....
- Triangulation Station.....
- Points Between Which Distances Are Measured Indicated Thus.....
- Latitude and Longitude.....

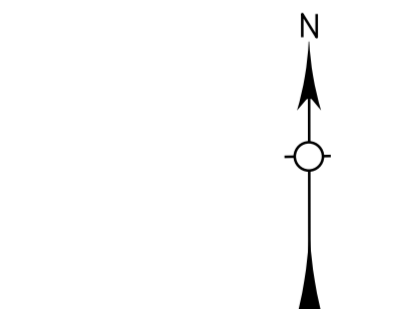
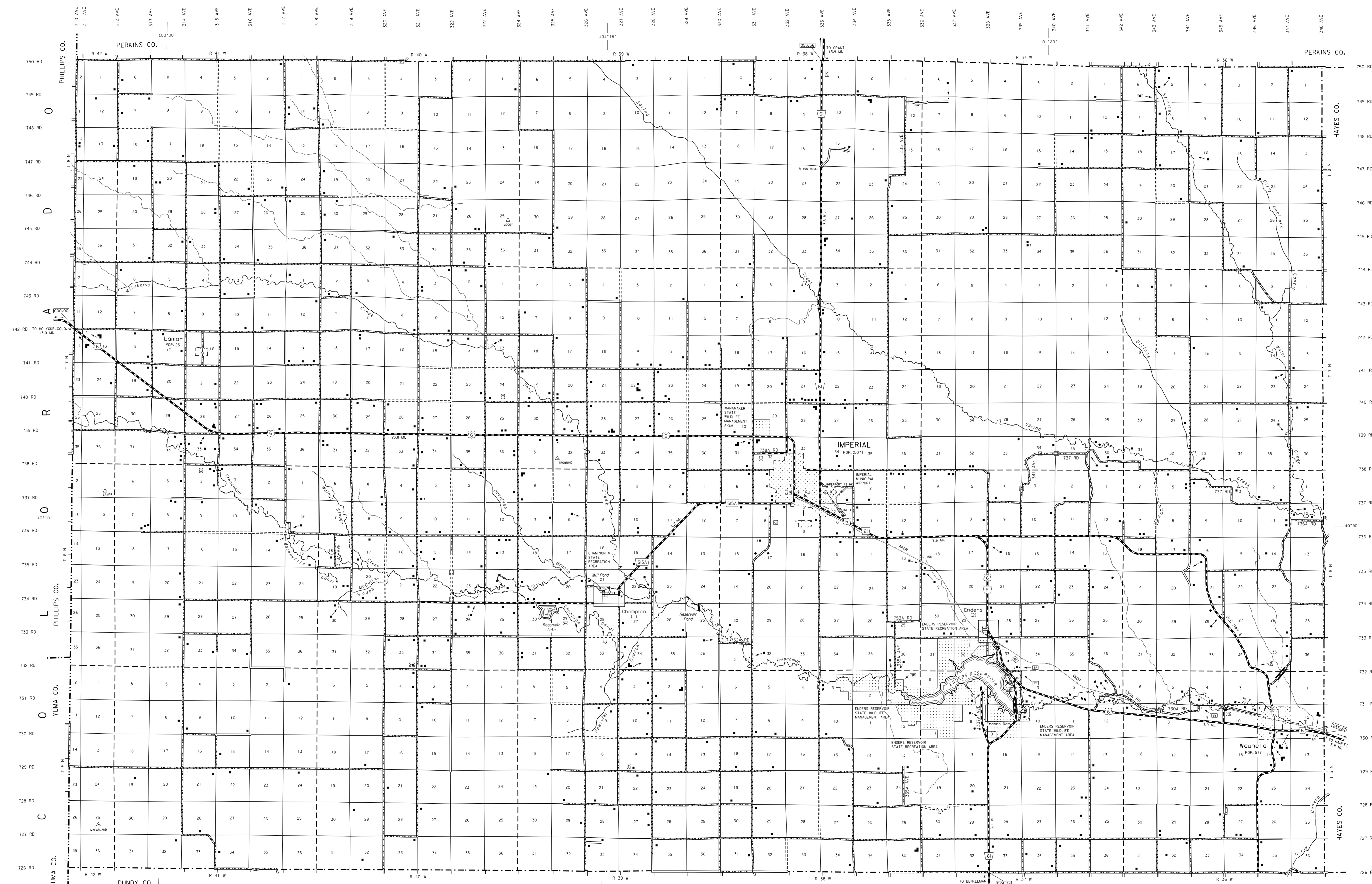
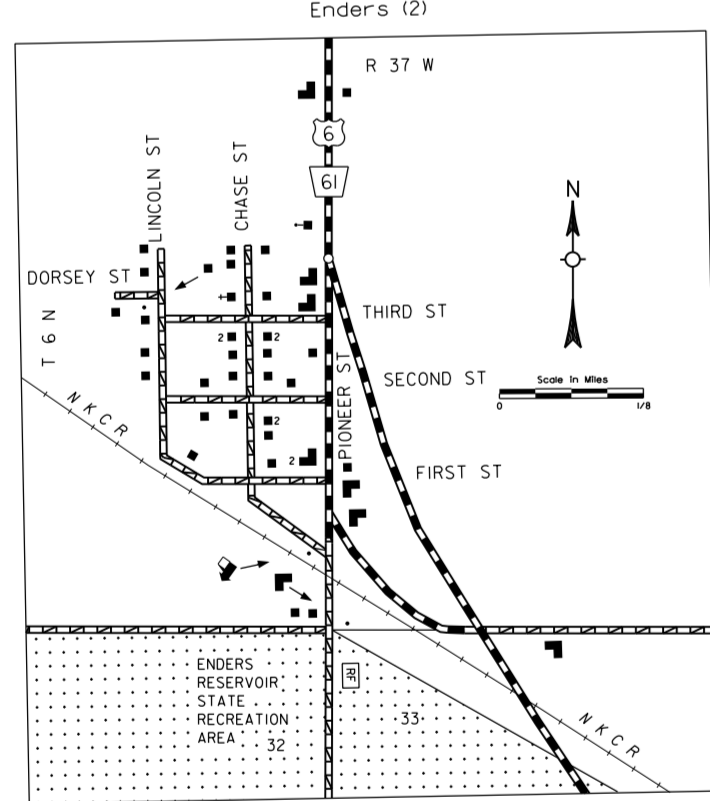
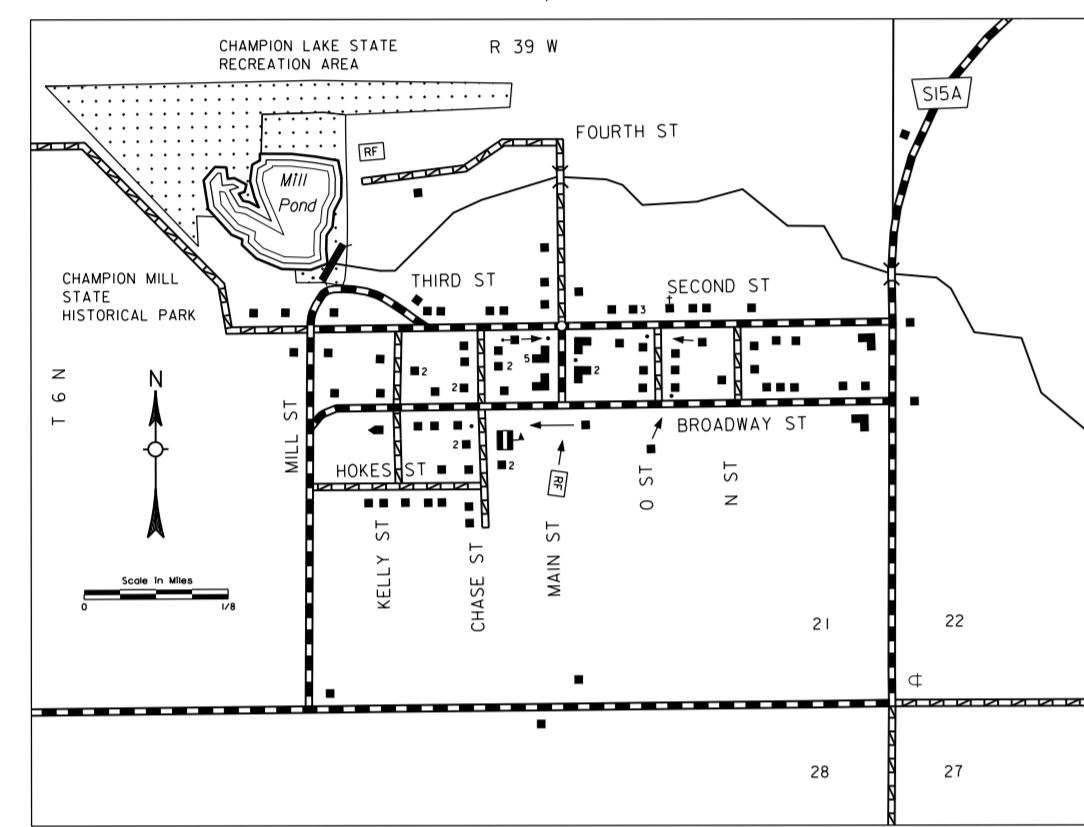

LAMBERT CONFORMAL CONIC PROJECTION  
1983 NORTH AMERICAN DATUM  
NEBRASKA COORDINATE SYSTEM

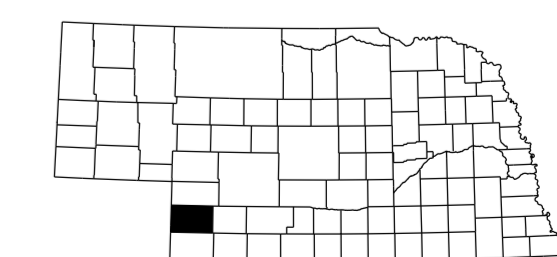

POPULATION AS OF 2010 CENSUS  
STATE HIGHWAYS CORRECTED TO 2011  
DIGITAL AERIAL PHOTOGRAPHY (DOADO)