

WEST POINT

CUMING COUNTY
NEBRASKA
POPULATION 3660 (2000 CENSUS)
2008
R 6 E

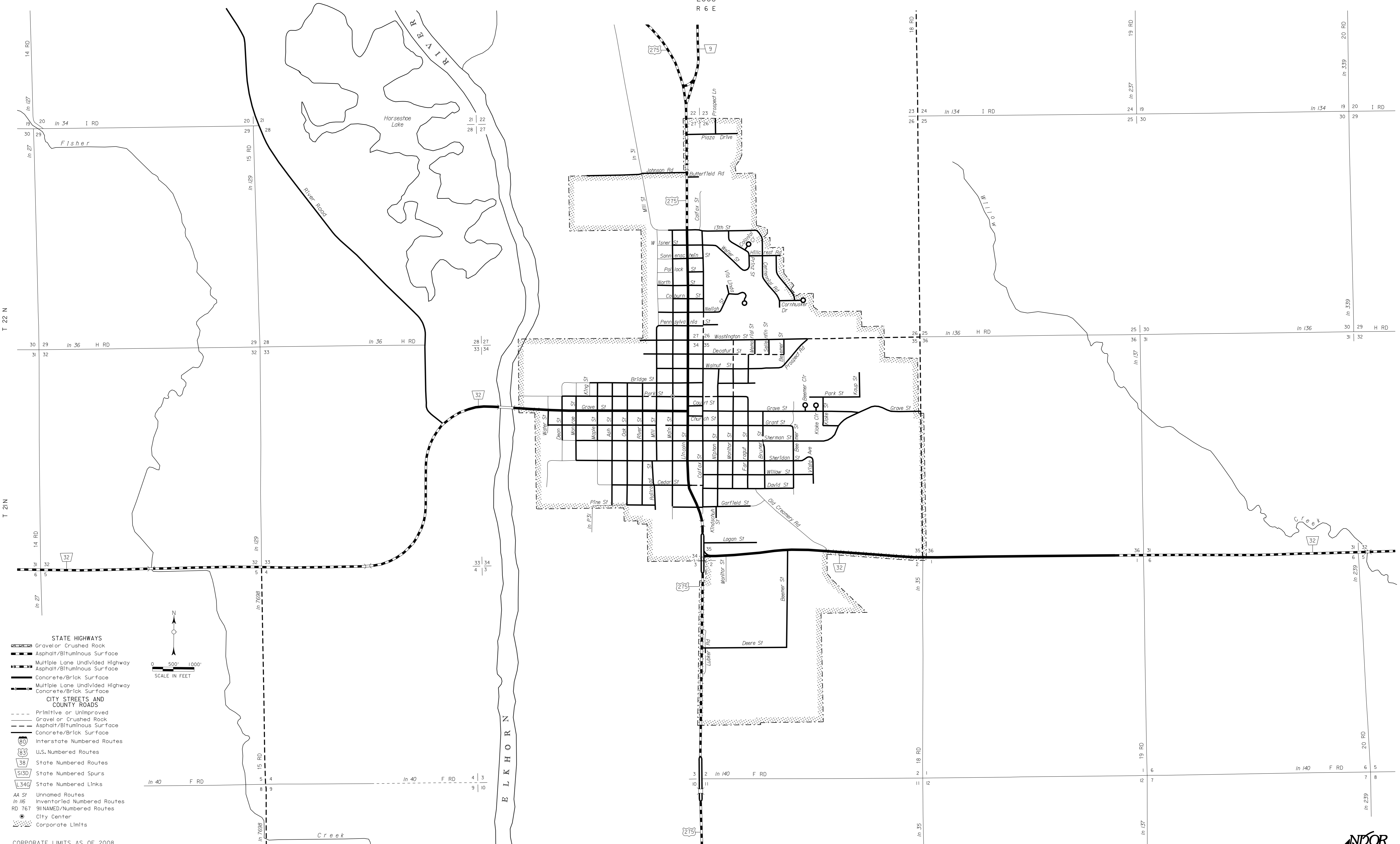

- STATE HIGHWAYS**
 - Gravel or Crushed Rock
 - Asphalt/Bituminous Surface
 - Multiple Lane Undivided Highway
 - Concrete/Brick Surface
 - Multiple Lane Undivided Highway
- CITY STREETS AND COUNTY ROADS**
 - Primitive or Unimproved
 - Gravel or Crushed Rock
 - Asphalt/Bituminous Surface
 - Concrete/Brick Surface
- Interstate Numbered Routes
- U.S. Numbered Routes
- State Numbered Routes
- State Numbered Spurs
- State Numbered Links
- AA St Unnamed Routes
- In 116 Invented/Numbered Routes
- RD 767 911 NAMED/Numbered Routes
- City Center
- Corporate Limits

CORPORATE LIMITS AS OF 2008
STATE HIGHWAYS CORRECTED TO 2008