

WAHOO

SAUNDERS COUNTY
NEBRASKA
POPULATION 3942 (2000 CENSUS)
2009

R 7 E

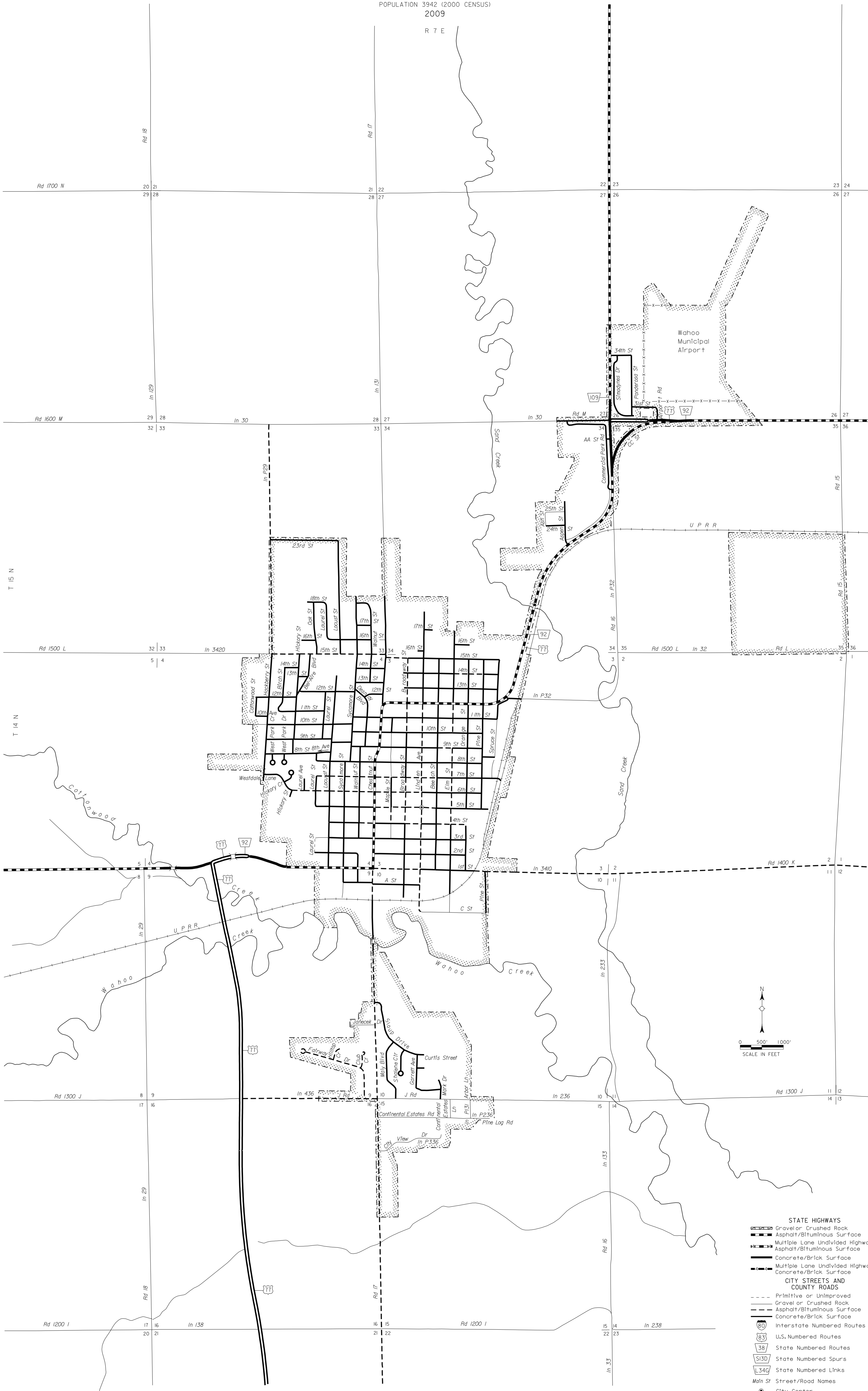

- STATE HIGHWAYS**
 - Gravel or Crushed Rock
 - Asphalt/Bituminous Surface
 - Multiple Lane Undivided Highway
 - Asphalt/Bituminous Surface
 - Concrete/Brick Surface
 - Multiple Lane Undivided Highway
 - Concrete/Brick Surface
- CITY STREETS AND COUNTY ROADS**
 - Primitive or Unimproved
 - Gravel or Crushed Rock
 - Asphalt/Bituminous Surface
 - Concrete/Brick Surface
- INTERSTATE/STATE ROUTES**
 - Interstate Numbered Routes
 - U.S. Numbered Routes
 - State Numbered Routes
 - State Numbered Spurs
 - State Numbered Links
- STREET/ROAD NAMES**
 - Main St
 - City Center
 - Corporate Limits

CORPORATE LIMITS AS OF 2009
STATE HIGHWAYS CORRECTED TO 2009



NDOR makes no warranties, guarantees, or representations for accuracy of this information and assumes no liability for errors or omissions. Users verify the placement of any errors or omissions identified in this data.