

# ROYAL

ANTELOPE COUNTY  
NEBRASKA

POPULATION 75 (2000 CENSUS)  
2007

R 7 W

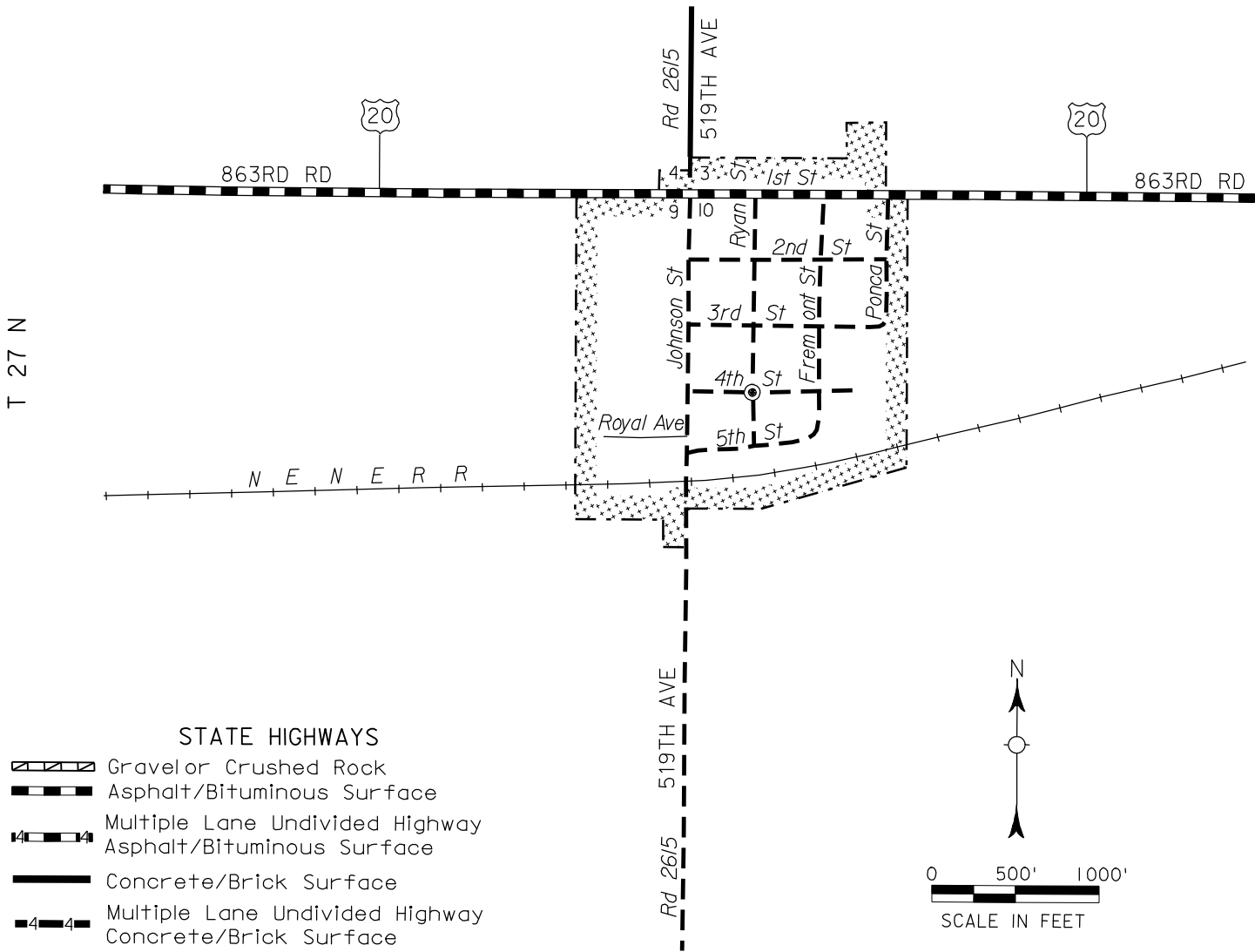

## STATE HIGHWAYS

- Gravel or Crushed Rock
- Asphalt/Bituminous Surface
- Multiple Lane Undivided Highway  
Asphalt/Bituminous Surface
- Concrete/Brick Surface
- Multiple Lane Undivided Highway  
Concrete/Brick Surface

## CITY STREETS AND COUNTY ROADS

- Primitive or Unimproved
- Gravel or Crushed Rock
- Asphalt/Bituminous Surface
- Concrete/Brick Surface
- Interstate Numbered Routes
- U.S. Numbered Routes
- State Numbered Routes
- State Numbered Spurs
- State Numbered Links
- AA St* Unnamed Routes
- In 116* Inventoried Numbered Routes
- RD 767* 911NAMED/Numbered Routes
- City Center
- Corporate Limits

CORPORATE LIMITS AS OF 2007  
STATE HIGHWAYS CORRECTED TO 2007

