

ROCKVILLE

SHERMAN COUNTY
NEBRASKA

POPULATION 111 (2000 CENSUS)

2005

R 13 W

T 13 N

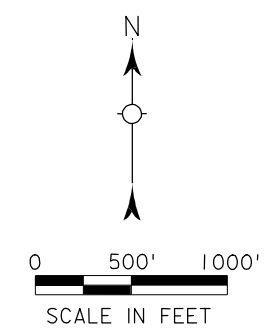
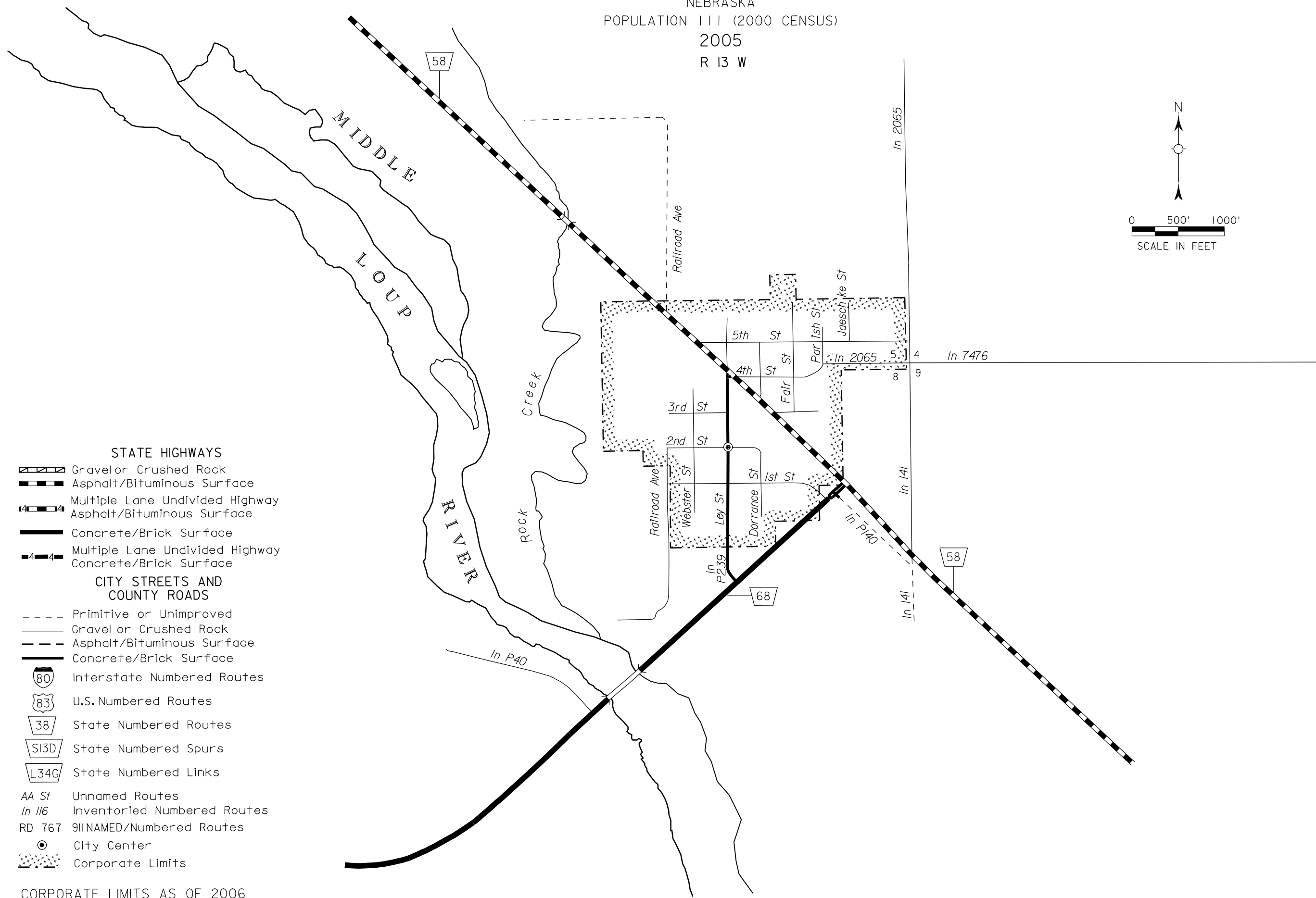

STATE HIGHWAYS

- Gravel or Crushed Rock
- Asphalt/Bituminous Surface
- Multiple Lane Undivided Highway Asphalt/Bituminous Surface
- Concrete/Brick Surface
- Multiple Lane Undivided Highway Concrete/Brick Surface

CITY STREETS AND COUNTY ROADS

- Primitive or Unimproved
- Gravel or Crushed Rock
- Asphalt/Bituminous Surface
- Concrete/Brick Surface
- Interstate Numbered Routes
- U.S. Numbered Routes
- State Numbered Routes
- State Numbered Spurs
- State Numbered Links

- Unnamed Routes
- Inventoried Numbered Routes
- 911 NAMED/Numbered Routes
- City Center
- Corporate Limits

CORPORATE LIMITS AS OF 2006
STATE HIGHWAYS CORRECTED TO 2006

