

# NELIGH

ANTELOPE COUNTY  
NEBRASKA  
POPULATION 1660 (2000 CENSUS)  
1992

R 6 W

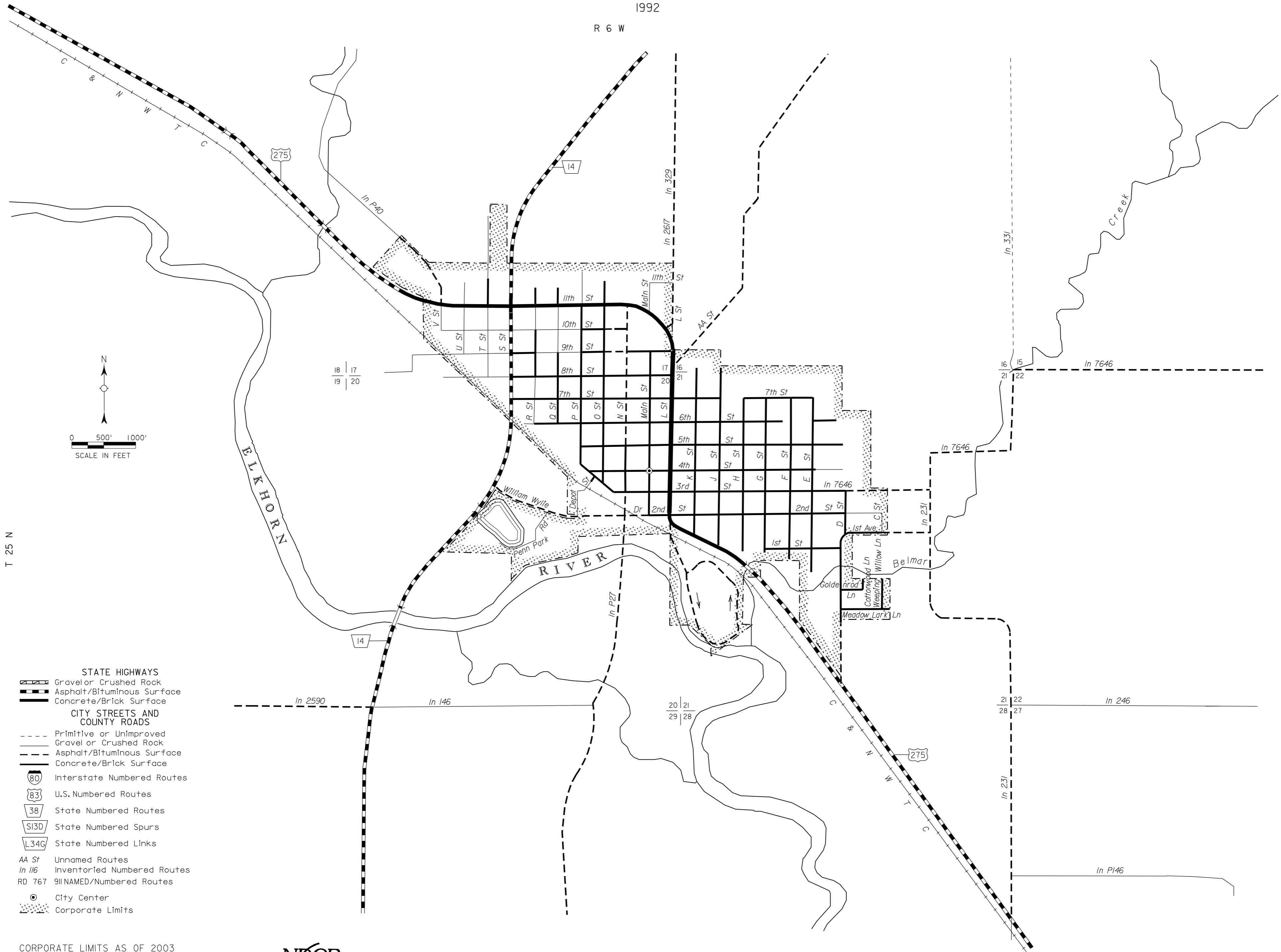

0 500' 1000'  
SCALE IN FEET

T 25 N

- STATE HIGHWAYS**
- Gravel or Crushed Rock
  - Asphalt/Bituminous Surface
  - Concrete/Brick Surface
- CITY STREETS AND COUNTY ROADS**
- Primitive or Unimproved Gravel or Crushed Rock
  - Asphalt/Bituminous Surface
  - Concrete/Brick Surface
- Interstate Numbered Routes
- U.S. Numbered Routes
- State Numbered Routes
- State Numbered Spurs
- State Numbered Links
- AA St* Unnamed Routes
- In 116* Inventoried Numbered Routes
- RD 767* 911 NAMED/Numbered Routes
- City Center
- Corporate Limits

CORPORATE LIMITS AS OF 2003  
STATE HIGHWAYS CORRECTED TO 2001

