

CEDAR RAPIDS

BOONE COUNTY
NEBRASKA

POPULATION 407 (2000 CENSUS)

1996

R 7 W

T 18 N

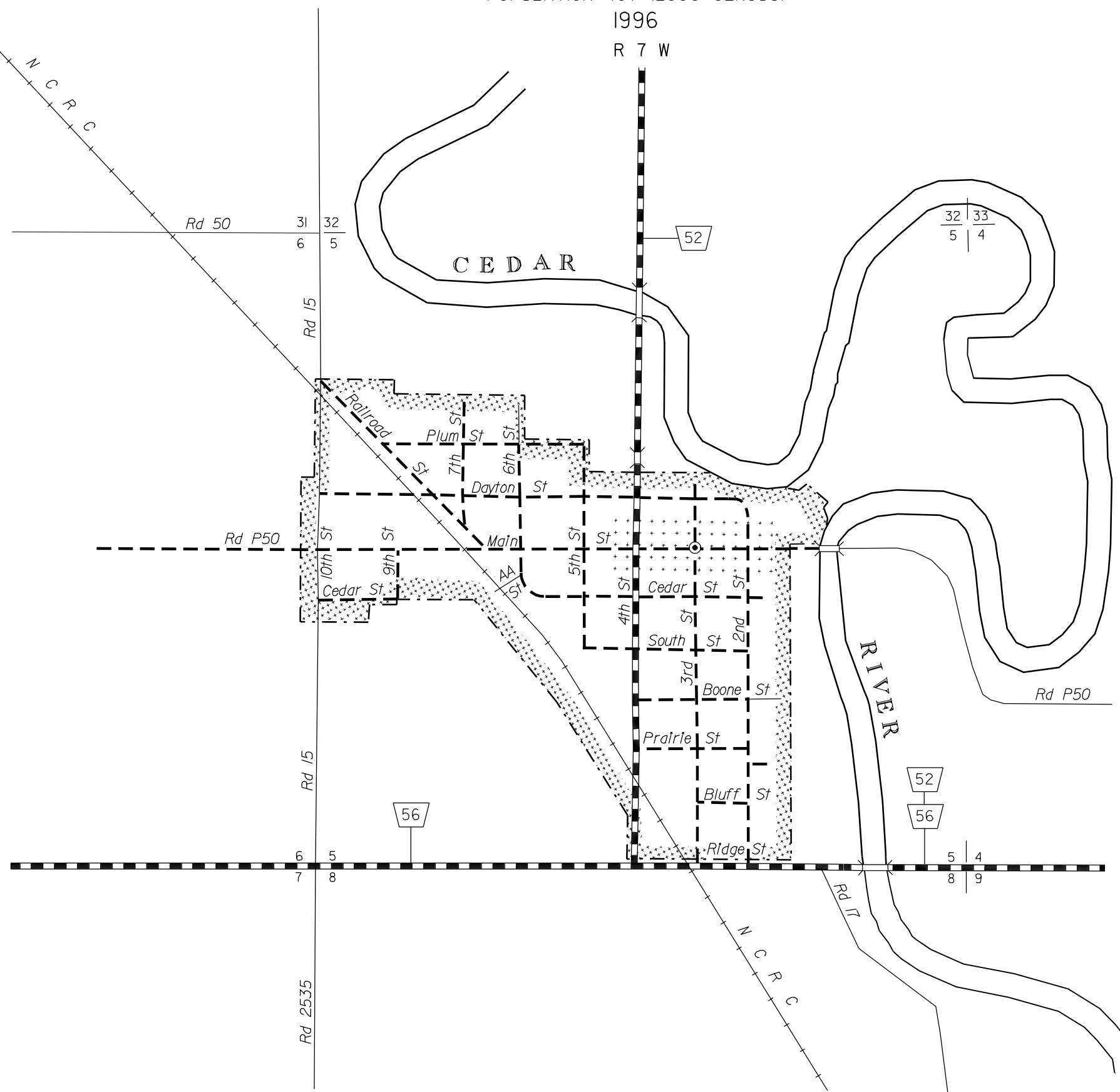
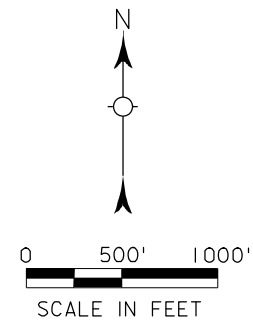

- STATE HIGHWAYS**
- Gravel or Crushed Rock
 - Asphalt/Bituminous Surface
 - Concrete/Brick Surface
- CITY STREETS AND COUNTY ROADS**
- Primitive or Unimproved
 - Gravel or Crushed Rock
 - Asphalt/Bituminous Surface
 - Concrete/Brick Surface
 - Interstate Numbered Routes
 - U.S. Numbered Routes
 - State Numbered Routes
 - State Numbered Spurs
 - State Numbered Links
 - In 116* Inventoried Numbered Routes
 - Ma 1480* Major Collector Routes
 - MI 7100* Minor Collector Routes
 - Ur 5092* Urban Routes
 - RD 767* 911 NAMED/Numbered Routes
 - City Center
 - Corporate Limits

CORPORATE LIMITS AS OF 1999
STATE HIGHWAYS CORRECTED TO 1998

Rev 10-99

