

ALMA
 HARLAN COUNTY
 NEBRASKA
 POPULATION 1214 (2000 CENSUS)
 1993

R 18 W

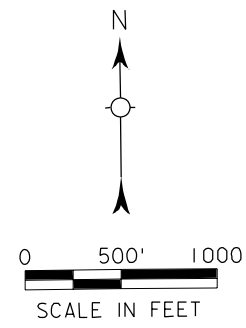
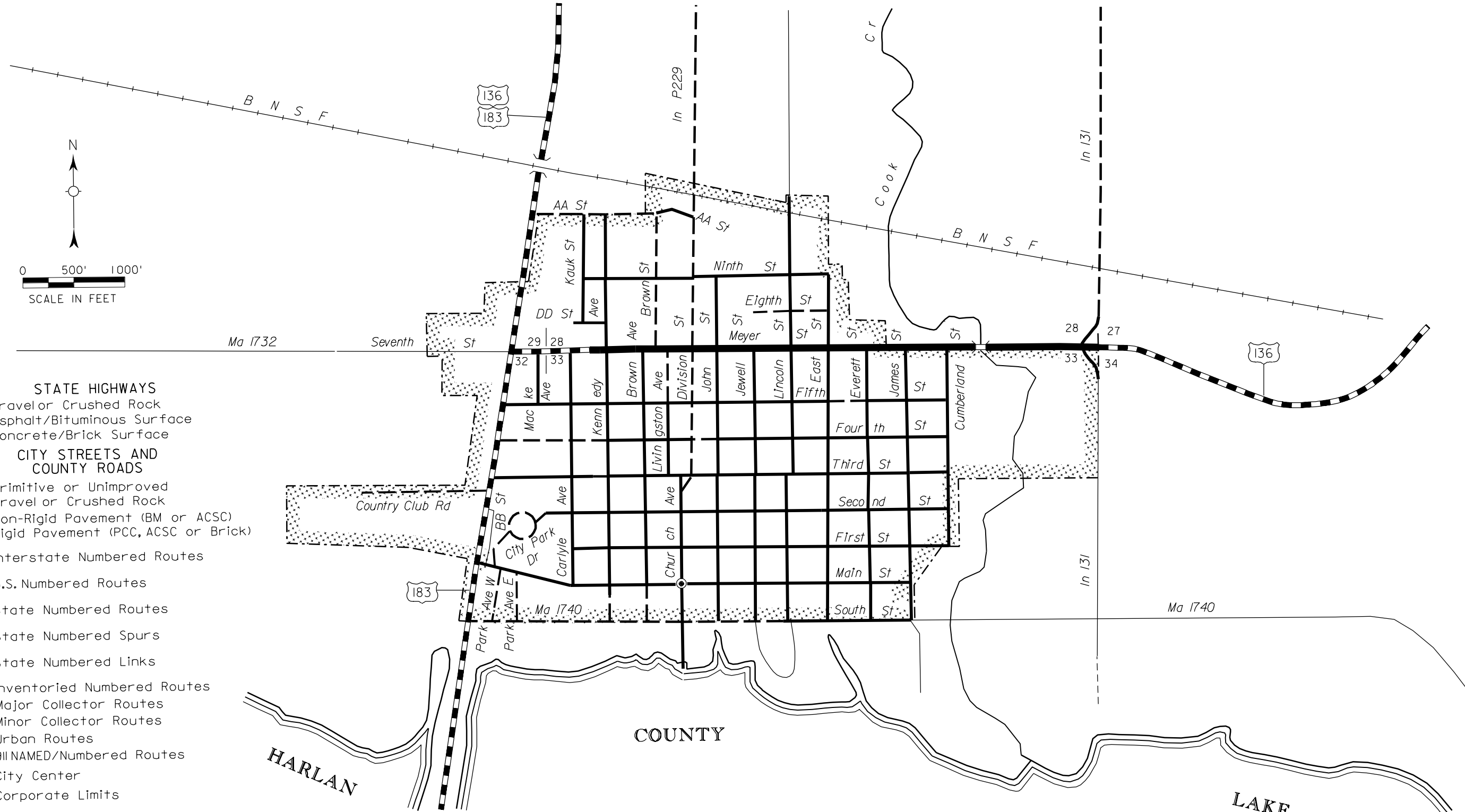

T 2 N

- STATE HIGHWAYS**
- Gravel or Crushed Rock
 - Asphalt/Bituminous Surface
 - Concrete/Brick Surface
- CITY STREETS AND COUNTY ROADS**
- Primitive or Unimproved
 - Gravel or Crushed Rock
 - Non-Rigid Pavement (BM or ACSC)
 - Rigid Pavement (PCC, ACSC or Brick)
- Interstate Numbered Routes
- U.S. Numbered Routes
- State Numbered Routes
- State Numbered Spurs
- State Numbered Links
- In 116* Inventoried Numbered Routes
- Ma 1480* Major Collector Routes
- Mi 7100* Minor Collector Routes
- Ur 5092* Urban Routes
- RD 767* 911 NAMED/Numbered Routes
- City Center
- Corporate Limits

CORPORATE LIMITS AS OF 2001
 STATE HIGHWAYS CORRECTED TO 2001

