

ADAMS

GAGE COUNTY
NEBRASKA

POPULATION 489 (2000 CENSUS)

2004

R 8 E

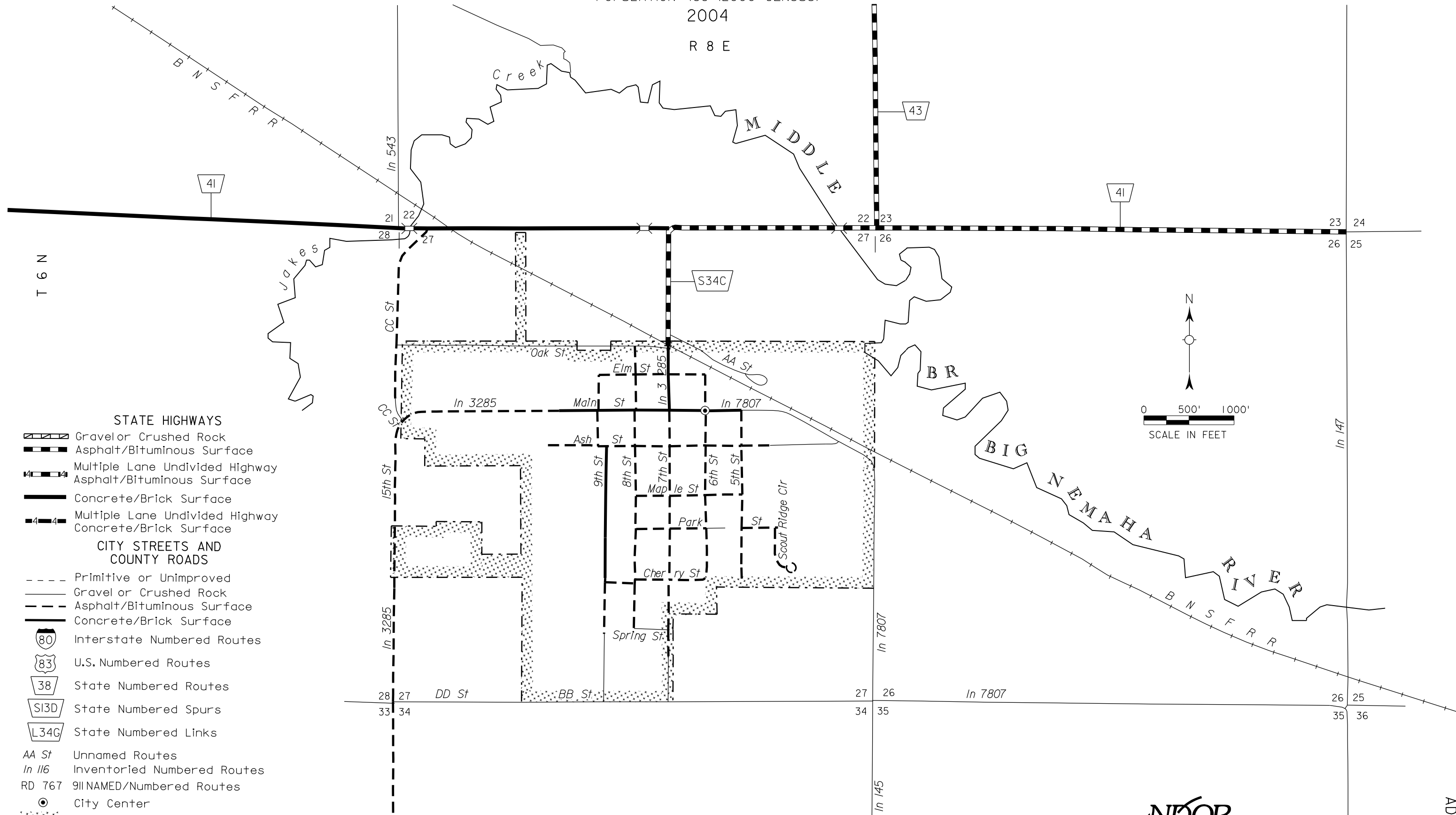

STATE HIGHWAYS

- Gravel or Crushed Rock
- Asphalt/Bituminous Surface
- Multiple Lane Undivided Highway Asphalt/Bituminous Surface
- Concrete/Brick Surface
- Multiple Lane Undivided Highway Concrete/Brick Surface

CITY STREETS AND COUNTY ROADS

- Primitive or Unimproved
- Gravel or Crushed Rock
- Asphalt/Bituminous Surface
- Concrete/Brick Surface
- Interstate Numbered Routes
- U.S. Numbered Routes
- State Numbered Routes
- State Numbered Spurs
- State Numbered Links
- AA St Unnamed Routes
- In 116 Inventoried Numbered Routes
- RD 767 UNNAMED/Numbered Routes
- City Center
- Corporate Limits

CORPORATE LIMITS AS OF 2004
STATE HIGHWAYS CORRECTED TO 2004

